

TOWN OF HINESBURG
DRIVEWAY OR NEW ROAD PERMIT

NAME: Joseph Laster
ADDRESS: Property: East of Mechanicsville
Road, Parcel # 6-625.1
TELEPHONE: 404.822.6990
EMAIL ADDRESS: abeprops@gmail.com

TYPE OF PERMIT REQUESTED: DRIVEWAY _____ NEW ROAD X
NAME OF ROAD BEING INTERSECTED: Mechanicsville Road



APPLICANT'S SIGNATURE: [Signature] DATE: 2/2/22
LANDOWNER'S SIGNATURE: [Signature] DATE: 2/2/22

*Scaled map of driveway location **must** be attached to this application and meet applicable **VTrans standards for driveways and/or roadways per A-76, B-71A, and B-71B** which are located here: https://outside.vermont.gov/agency/vtrans/external/CADD/WebFiles/Downloads/Standards/VAOTconSTD_Owner.xml. Approvals for deviation from these standards are at the discretion of the Town /Town Engineer.

TO BE COMPLETED BY TOWN ENGINEER

NOTE: ALL DRIVEWAYS THAT NEED CULVERTS WILL BE STIPULATED BY THE TOWN ENGINEER. THE SIZE OF THE CULVERT NEEDED WILL ALSO BE STIPULATED BY THE HIGHWAY FOREMAN (MINIMUM DIAMETER OF 15"). ALL CULVERTS WILL HAVE FLAT STONE OR CONCRETE HEADERS, AS WELL AS LOCATION POSTS AT EACH END (6" TREATED MINIMUM). ALL DISTURBED AREAS WILL BE MULCHED AND SEEDED OR RIP-RAPPED FOR APPROPRIATE EROSION CONTROL. THIS PERMIT EXPIRES NINE (9) MONTHS FROM DATE OF ISSUE BY THE TOWN OF HINESBURG.

REMARKS: _____

This permit is issued subject to the terms and conditions of all State and Local Permits governing the development of this parcel.

FEE: \$125.00 PAYABLE TO THE TOWN OF HINESBURG attention Town Manager's Office, 10632 Vt Rte 116 Hinesburg, Vt 05461

APPROVED BY THE TOWN OF HINESBURG

SIGNATURE

DATE:

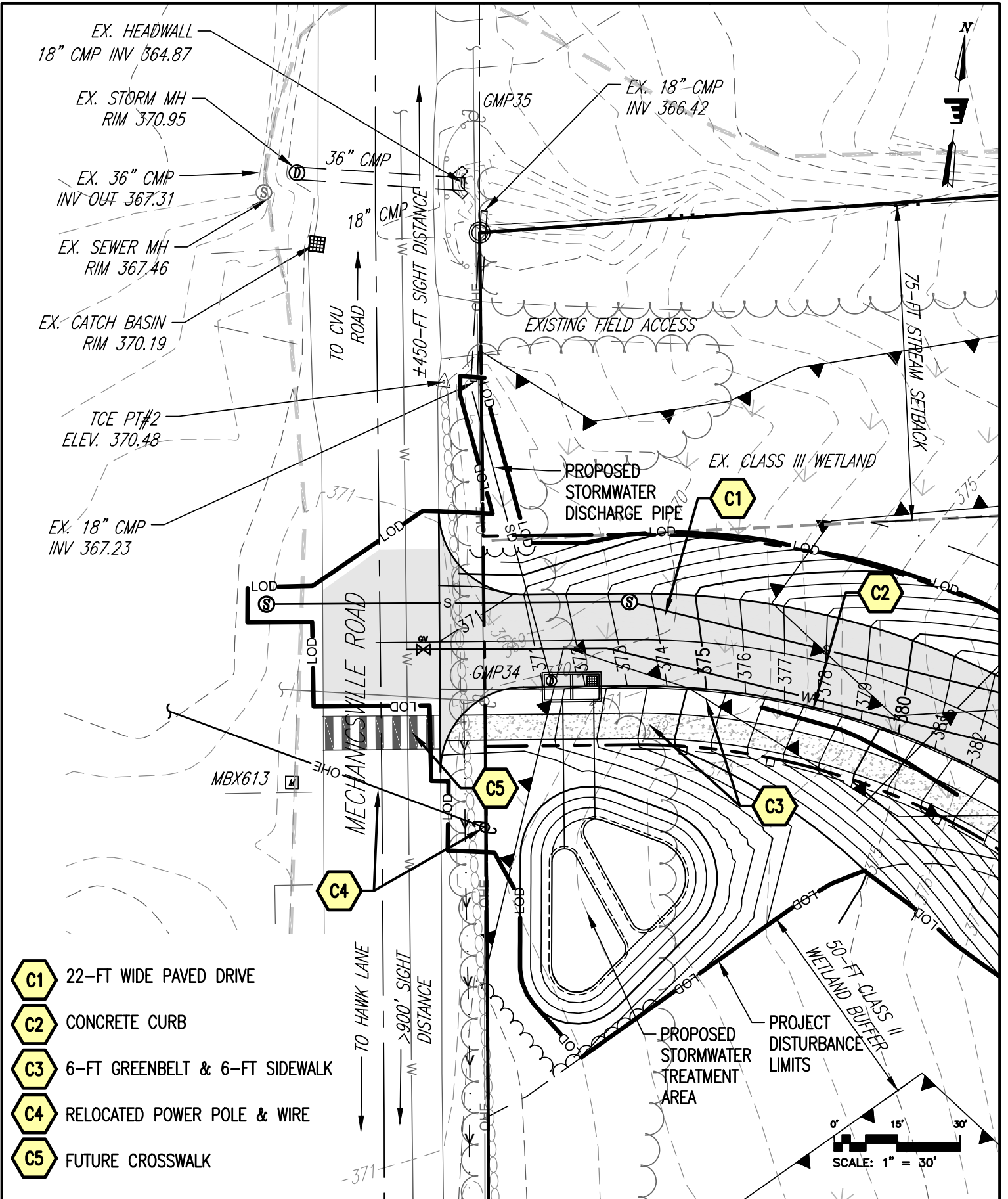

- C1** 22-FT WIDE PAVED DRIVE
- C2** CONCRETE CURB
- C3** 6-FT GREENBELT & 6-FT SIDEWALK
- C4** RELOCATED POWER POLE & WIRE
- C5** FUTURE CROSSWALK

ENGINEERING VENTURES PC
 208 Flynn Ave, Suite 2A, Burlington, VT 05401
 85 Mechanic St, Suite E2-3, Lebanon, NH 03766
 414 Union St, Schenectady, NY 12305
 www.engineeringventures.com

Sheet Title: **CURB CUT SKETCH PLAN MECHANICSVILLE ROAD**

Project Title: **LASTER PROPERTY**

EV Project #	20542
Drawn By:	HKW
Checked By:	KW
Scale:	1" = 30'
Date:	02/01/2022

Figure: **SK-1**