

**NOTES:**

- ALL SEWER SERVICES SHALL BE 4" SDR 35 PVC @ 2.0% (MIN) U.N.O.
- ALL WATER SERVICES SHALL BE 1" TYPE 'K' COPPER U.N.O.

SITE ENGINEER:



CIVIL ENGINEERING ASSOCIATES, INC.  
10 MANSFIELD VIEW LANE, SOUTH BURLINGTON, VT 05403  
802-864-2323 FAX: 802-864-2271 web: www.cea-vt.com

COPYRIGHT © 2019 - ALL RIGHTS RESERVED

DRAWN  
**SAL**  
CHECKED  
**DSM**  
APPROVED  
**DSM**

OWNER:  
**HAYSTACK  
CROSSING, LLC**  
c/o JOSEPH BISSONETTE

68 RANDALL STREET  
SOUTH BURLINGTON, VT 05403

APPLICANT:  
**BLACKROCK  
CONSTRUCTION, LLC**

68 RANDALL STREET  
SOUTH BURLINGTON, VT 05403

PROJECT:

**HAYSTACK  
CROSSING**

SHELburnE FALLS ROAD  
VERMONT ROUTE 116  
HINESBURG, VERMONT 05461



LOCATION MAP

1" = 2000'

DATE	CHECKED	REVISION
11/22/19	DSM	TOWN RESUBMITTAL
1/10/20	DSM	UPDATE PER TOWN COMMENTS
3/4/22	DSM	REV. PER CONDITIONS OF APPROVAL

**PARTIAL SITE PLAN  
WATER & SEWER**

DATE  
**OCT. 4, 2019**

SCALE  
**1" = 20'**

PROJ. NO.  
**13127**

DRAWING NUMBER

**C4.5**

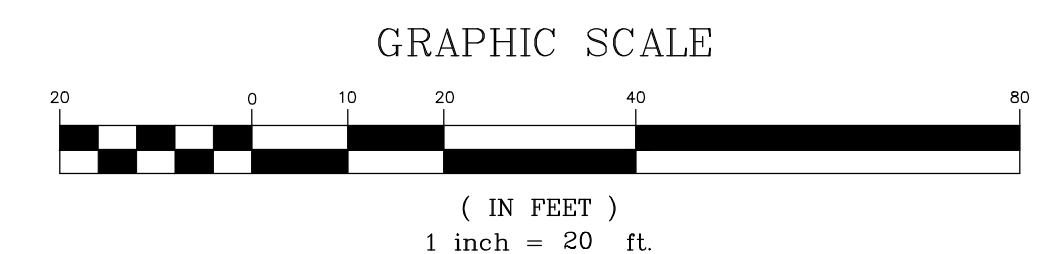
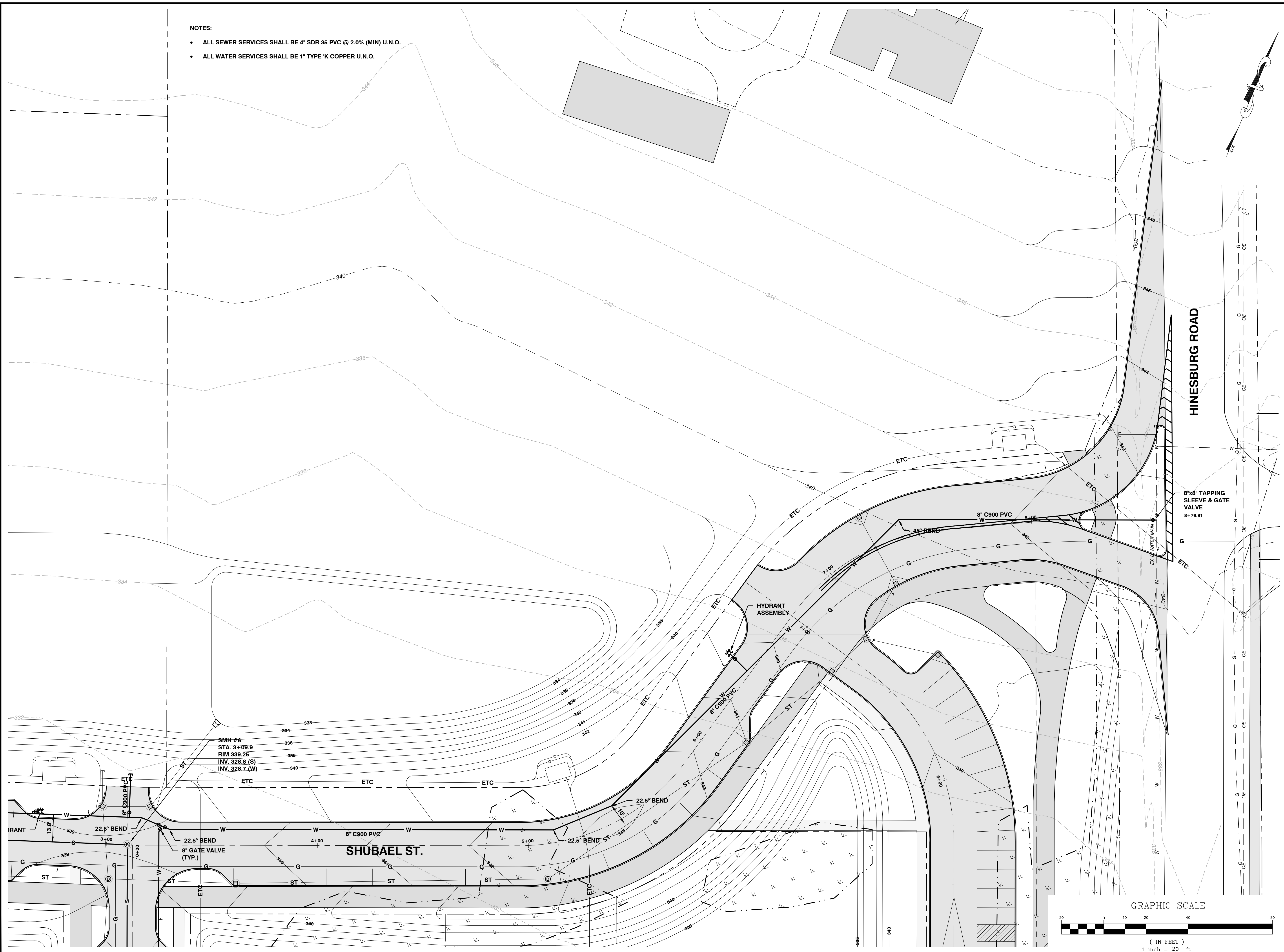

P:\AutoCAD Projects\2013\131271-CADD Files\131271-Dwg\131271-SITE.dwg, C4.5 - W&S, 3/14/2022 10:52:18 AM