

SITE ENGINEER:



CIVIL ENGINEERING ASSOCIATES, INC.
 10 MANSFIELD VIEW LANE, SOUTH BURLINGTON, VT 05403
 802-864-2323 FAX: 802-864-2271 web: www.cca-vt.com

COPYRIGHT © 2010 - ALL RIGHTS RESERVED

DRAWN SAL	
CHECKED DSM	
APPROVED DSM	

OWNER:
**HAYSTACK
 CROSSING, LLC**
 c/o JOSEPH BISSONETTE

88 RANDALL STREET
 SOUTH BURLINGTON, VT 05403

APPLICANT:
**BLACKROCK
 CONSTRUCTION, LLC**
 88 RANDALL STREET
 SOUTH BURLINGTON, VT 05403

PROJECT:
**HAYSTACK
 CROSSING**
 SHELburnE FALLS ROAD
 VERMONT ROUTE 116
 HINESBURG, VERMONT 05461

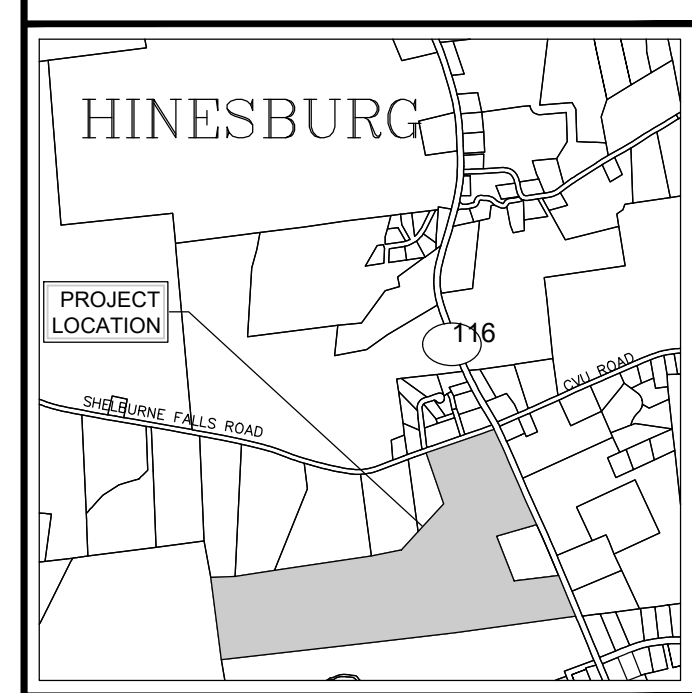

LOCATION MAP 1" = 2000'

DATE	CHECKED	REVISION

**PROPOSED
 CONDITIONS
 OVERALL SITE PLAN**

DATE JUN., 2020	DRAWING NUMBER C2.0
SCALE 1" = 80'	
PROJ. NO. 13127	

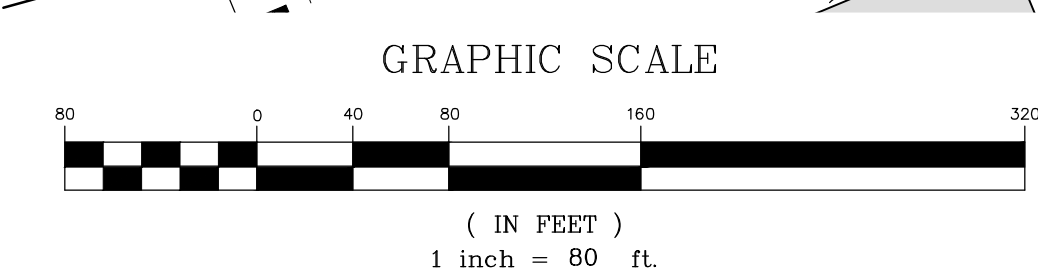

P:\AECAD\Projects\13127\CADD\13127.dwg, 13127.dwg, 6/22/20 10:58 AM

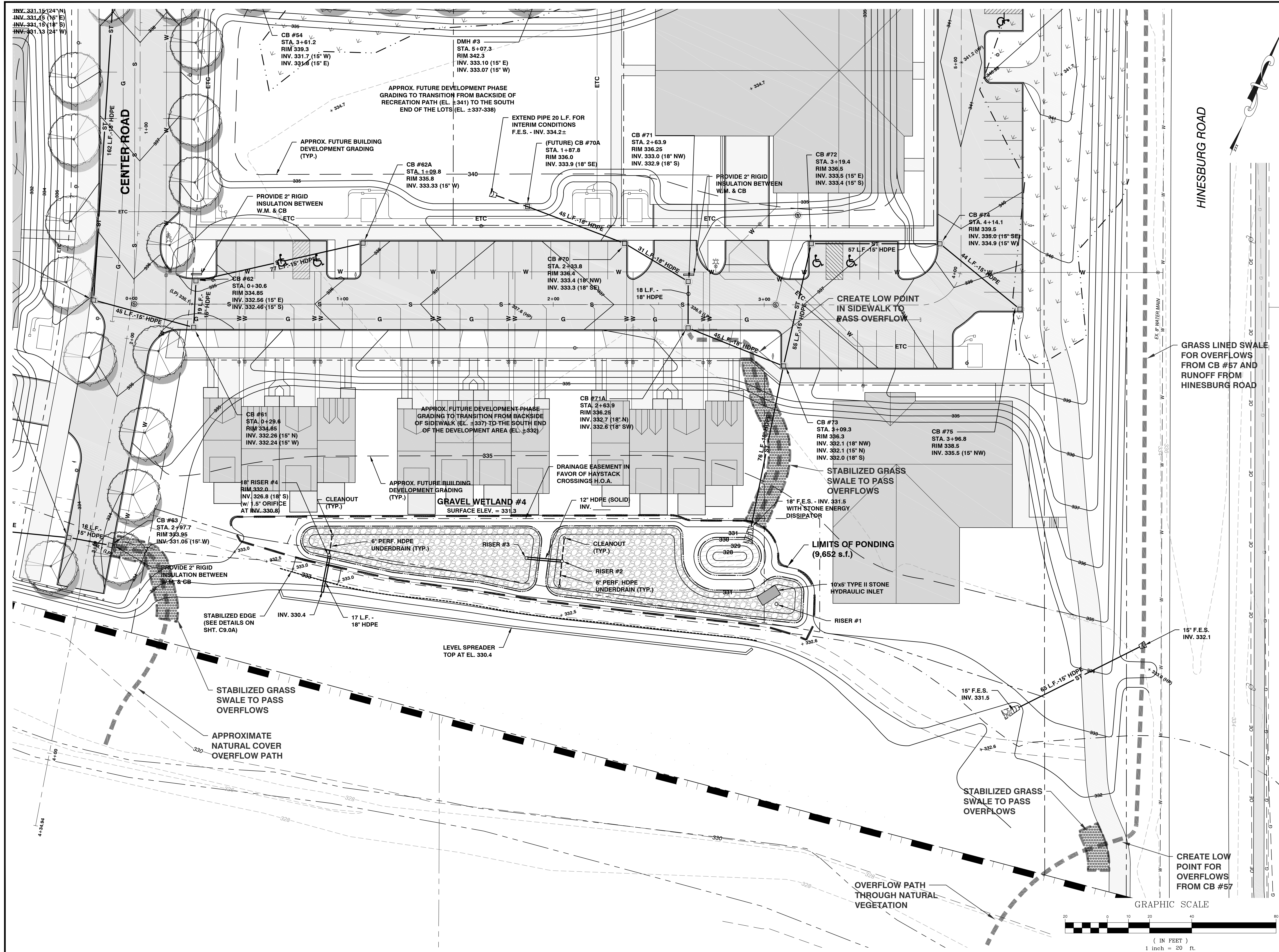

SITE ENGINEER:

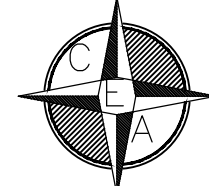

CIVIL ENGINEERING ASSOCIATES, INC.
10 MANSFIELD VIEW LANE, SOUTH BURLINGTON, VT 05403
802-864-2323 FAX: 802-864-2271 web: www.cca-vt.com

COPYRIGHT © 2010 - ALL RIGHTS RESERVED

DRAWN	SAL
CHECKED	DSM
APPROVED	DSM

OWNER:
HAYSTACK CROSSING, LLC
c/o JOSEPH BISSONETTE

68 RANDALL STREET
SOUTH BURLINGTON, VT 05403

APPLICANT:
BLACKROCK CONSTRUCTION, LLC
68 RANDALL STREET
SOUTH BURLINGTON, VT 05403

PROJECT:
HAYSTACK CROSSING

SHELburne FALLS ROAD
VERMONT ROUTE 116
HINESBURG, VERMONT 05461

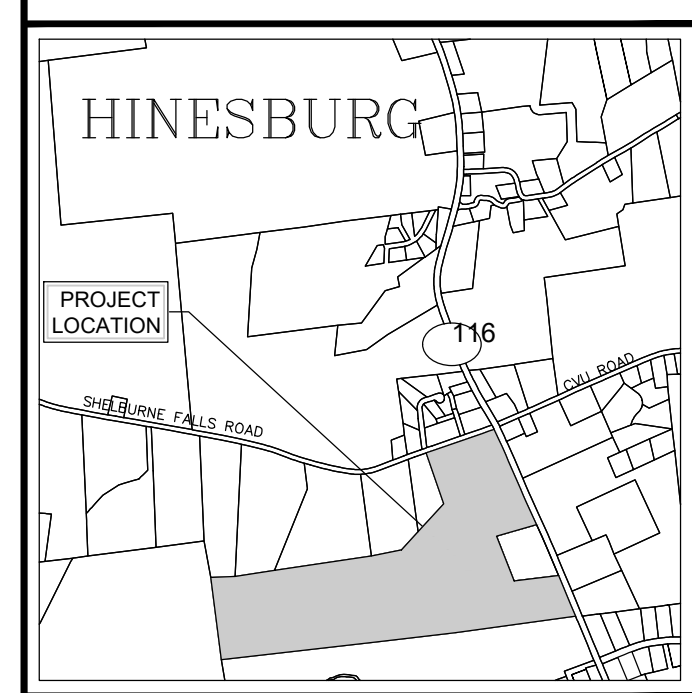

LOCATION MAP
1" = 2000'

DATE	CHECKED	REVISION

**PARTIAL SITE PLAN
GRADING &
DRAINAGE**

DATE	JUN., 2020	DRAWING NUMBER	C3.1
SCALE	1" = 20'	PROJ. NO.	13127

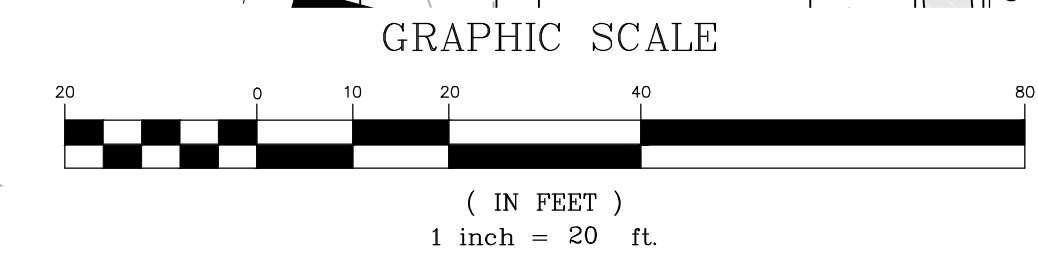

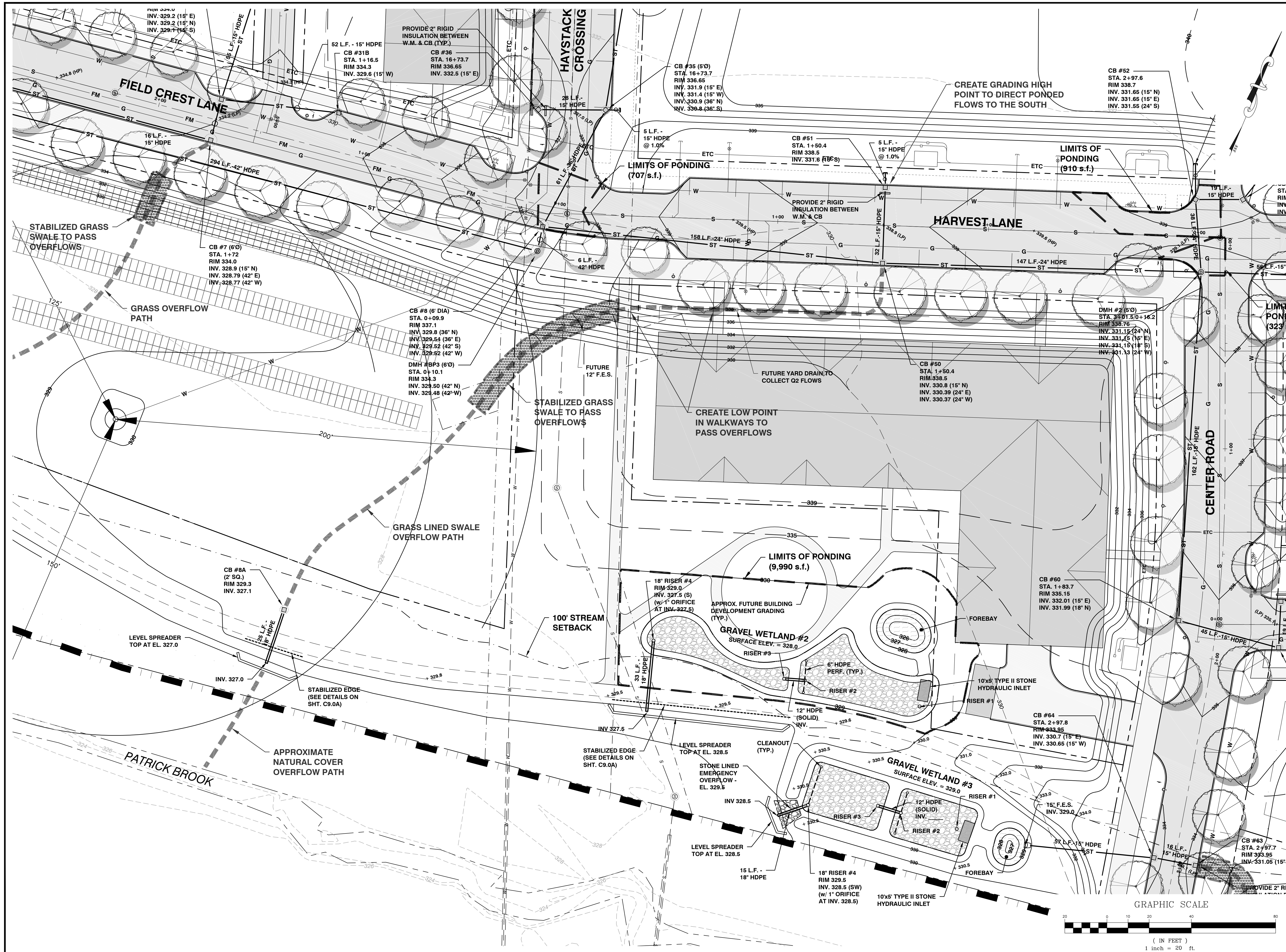

SITE ENGINEER:

 CIVIL ENGINEERING ASSOCIATES, INC.
 10 MANSFIELD VIEW LANE, SOUTH BURLINGTON, VT 05403
 802-864-2323 FAX: 802-864-2271 web: www.cca-vt.com
 COPYRIGHT © 2019 - ALL RIGHTS RESERVED

DRAWN: SAL
 CHECKED: DSM
 APPROVED: DSM

OWNER:
HAYSTACK CROSSING, LLC
 c/o JOSEPH BISSONETTE
 68 RANDALL STREET
 SOUTH BURLINGTON, VT 05403

APPLICANT:
BLACKROCK CONSTRUCTION, LLC
 68 RANDALL STREET
 SOUTH BURLINGTON, VT 05403

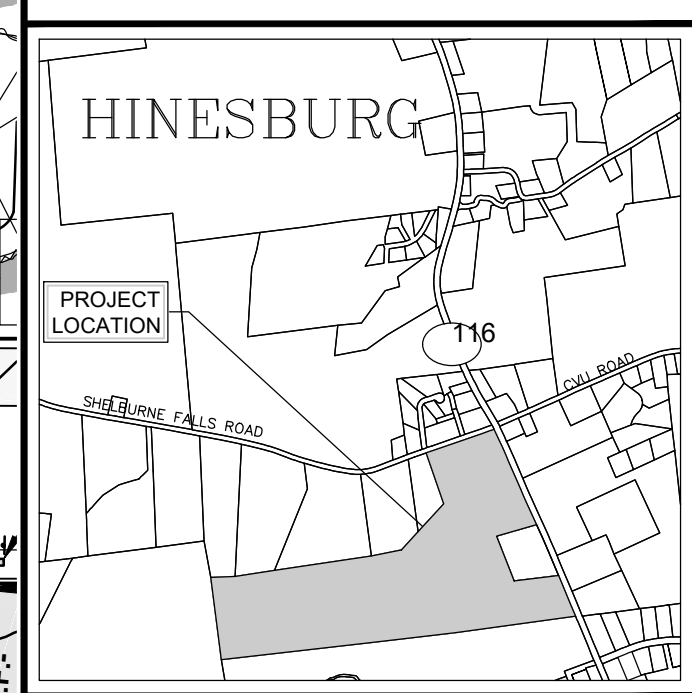
PROJECT:
HAYSTACK CROSSING
 SHELburne FALLS ROAD
 VERMONT ROUTE 116
 HINESBURG, VERMONT 05461



LOCATION MAP
 1" = 2000'

DATE	CHECKED	REVISION

**PARTIAL SITE PLAN
 GRADING &
 DRAINAGE**

DATE: JUN., 2020
 SCALE: 1" = 20'
 PROJ. NO.: 13127
 DRAWING NUMBER: **C3.2**

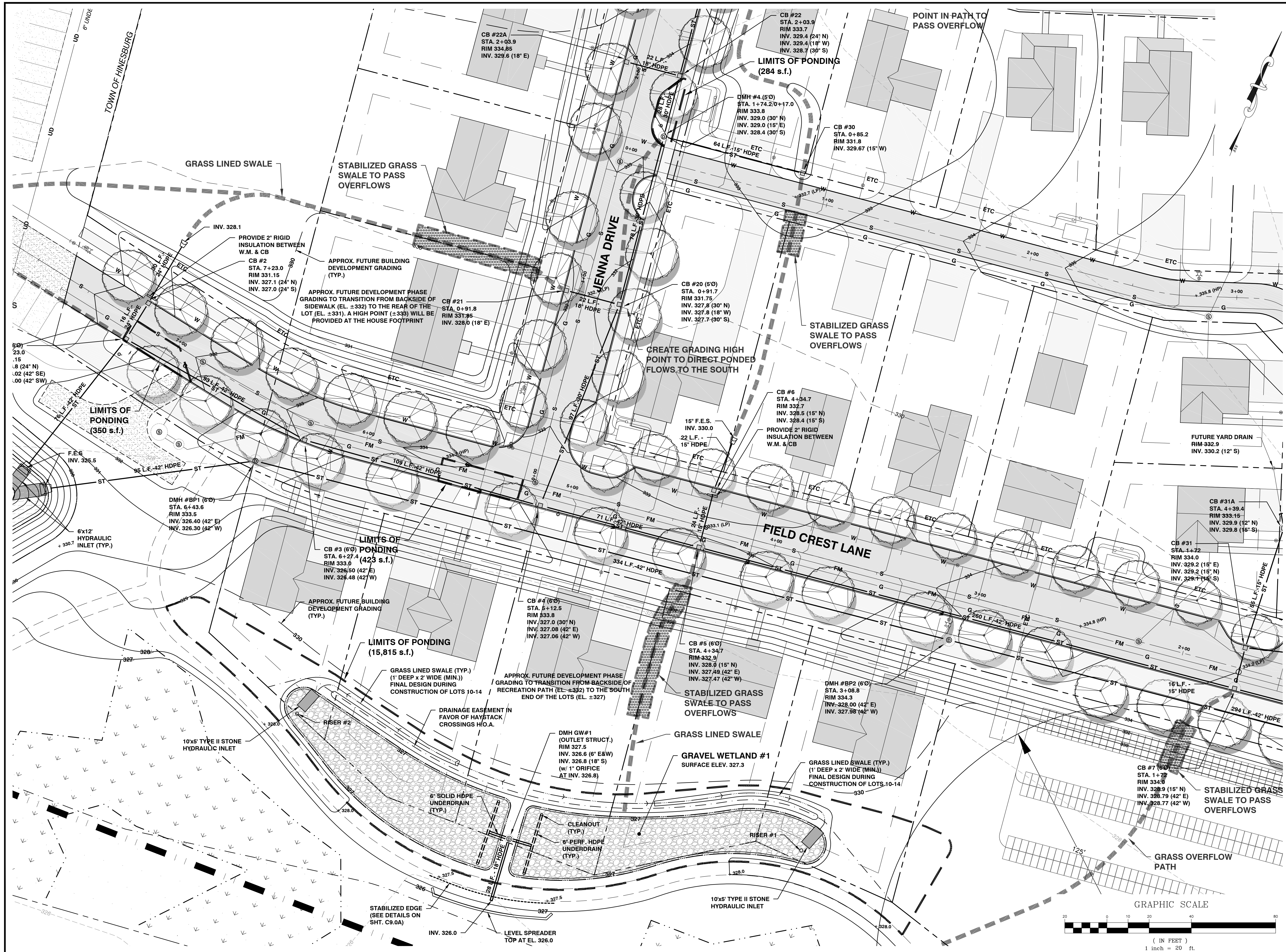

SITE ENGINEER:

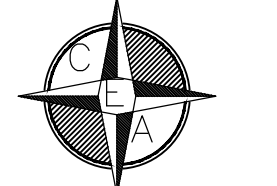

CIVIL ENGINEERING ASSOCIATES, INC.
 10 MANSFIELD VIEW LANE, SOUTH BURLINGTON, VT 05403
 802-864-2323 FAX: 802-864-2271 web: www.cca-vt.com

COPYRIGHT © 2010 - ALL RIGHTS RESERVED

DRAWN: SAL
 CHECKED: DSM
 APPROVED: DSM

OWNER:
HAYSTACK CROSSING, LLC
 c/o JOSEPH BISSONETTE
 68 RANDALL STREET
 SOUTH BURLINGTON, VT 05403

APPLICANT:
BLACKROCK CONSTRUCTION, LLC
 68 RANDALL STREET
 SOUTH BURLINGTON, VT 05403

PROJECT:
HAYSTACK CROSSING
 SHELburne FALLS ROAD
 VERMONT ROUTE 116
 HINESBURG, VERMONT 05461

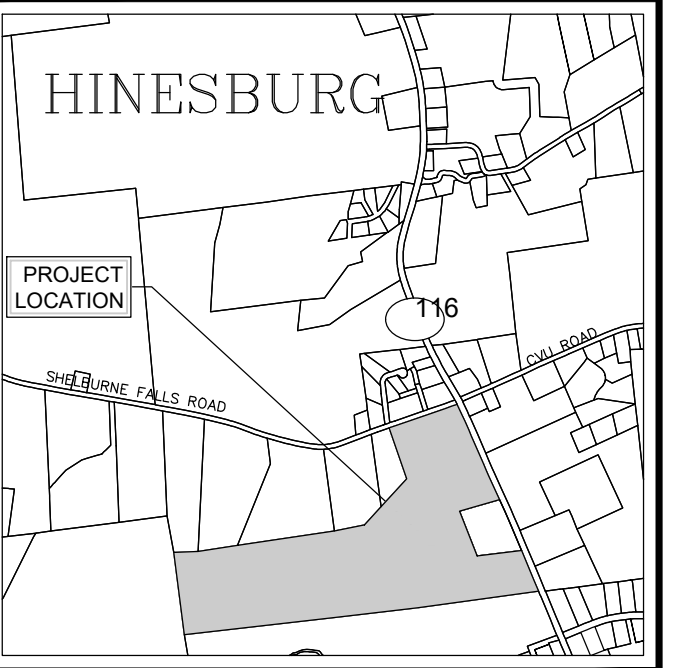

LOCATION MAP 1" = 2000'

DATE	CHECKED	REVISION

**PARTIAL SITE PLAN
 GRADING &
 DRAINAGE**

DATE: JUN., 2020
 SCALE: 1" = 20'
 PROJ. NO.: 13127
 DRAWING NUMBER: **C3.3**

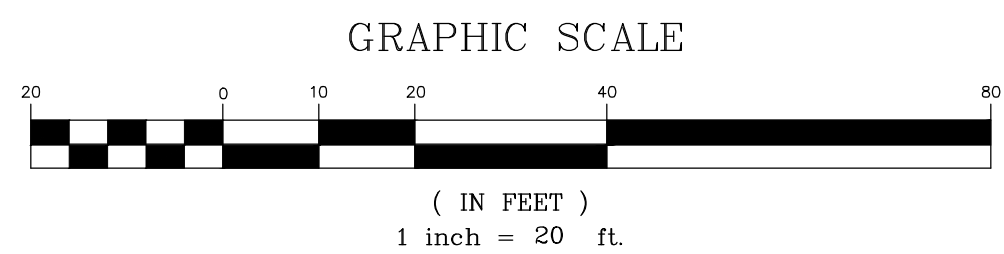

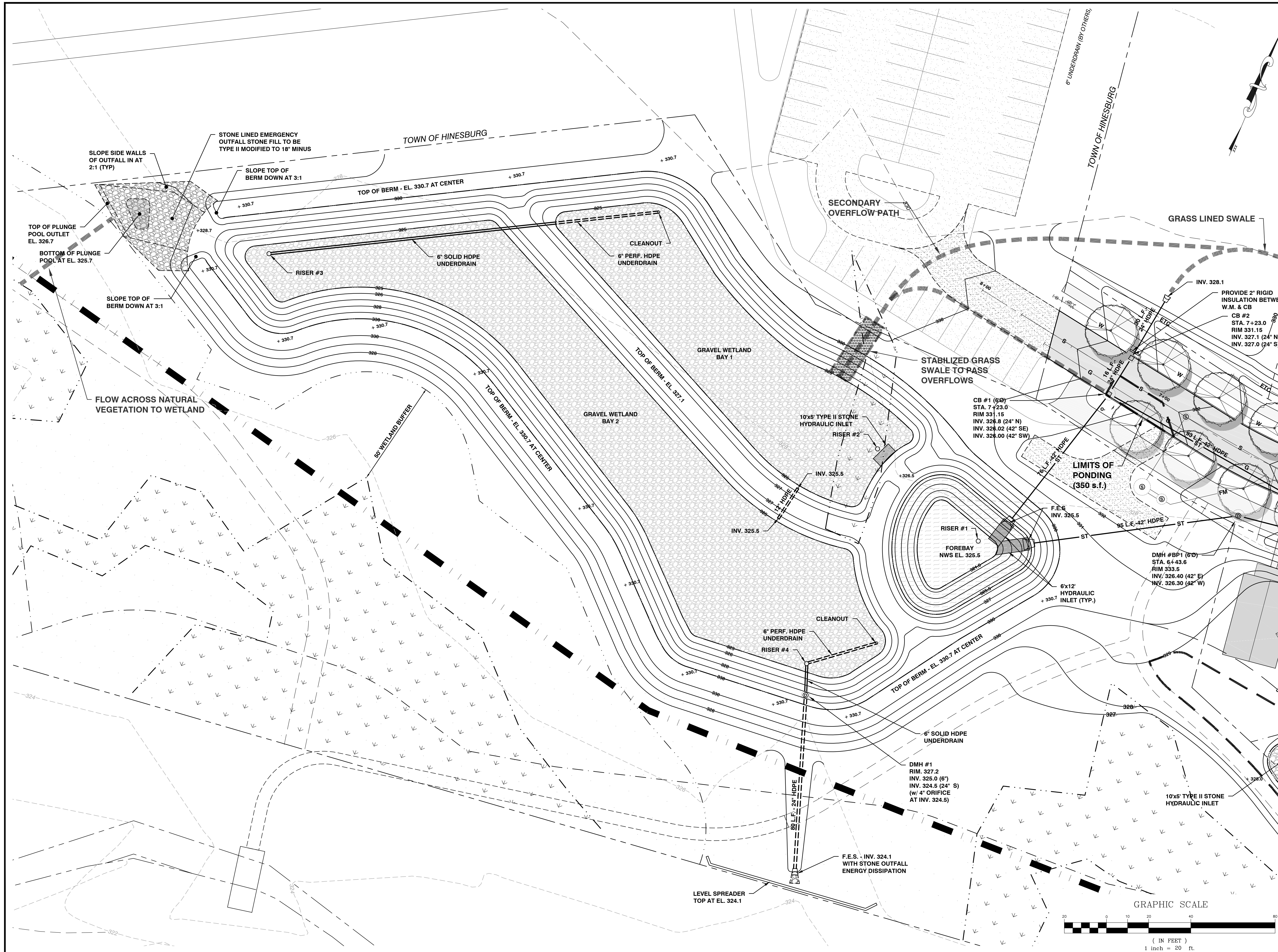

SITE ENGINEER:

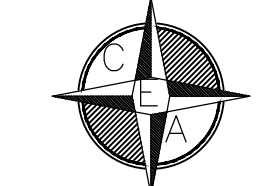

CIVIL ENGINEERING ASSOCIATES, INC.
 10 MANSFIELD VIEW LANE, SOUTH BURLINGTON, VT 05403
 802-864-2323 FAX: 802-864-2271 web: www.cca-vt.com

COPYRIGHT © 2010 - ALL RIGHTS RESERVED

DRAWN	SAL
CHECKED	DSM
APPROVED	DSM

OWNER:
HAYSTACK CROSSING, LLC
 c/o JOSEPH BISSONETTE

68 RANDALL STREET
 SOUTH BURLINGTON, VT 05403

APPLICANT:
BLACKROCK CONSTRUCTION, LLC
 68 RANDALL STREET
 SOUTH BURLINGTON, VT 05403

PROJECT:
HAYSTACK CROSSING
 SHELBURNE FALLS ROAD
 VERMONT ROUTE 116
 HINESBURG, VERMONT 05461

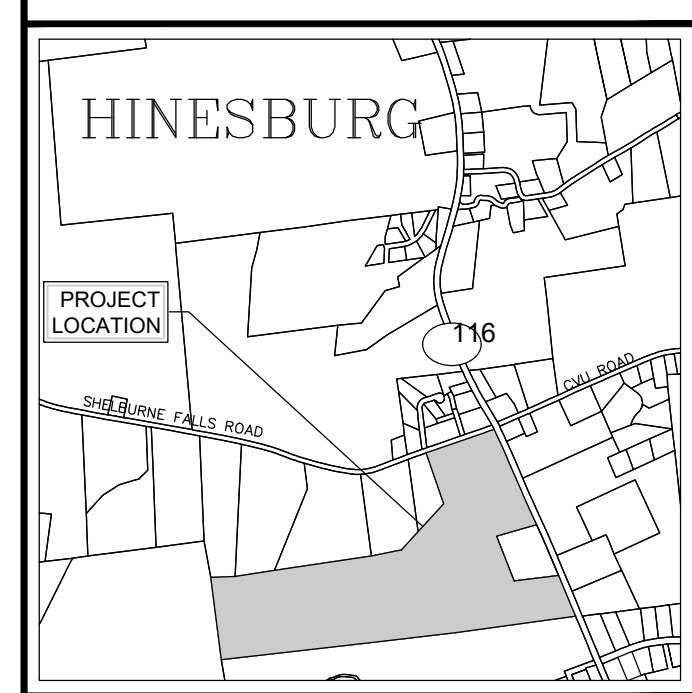

LOCATION MAP 1" = 2000'

DATE	CHECKED	REVISION

**PARTIAL SITE PLAN
 GRADING &
 DRAINAGE**

DATE	JUN., 2020	DRAWING NUMBER	C3.4	
SCALE	1" = 20'	PROJ. NO.		13127

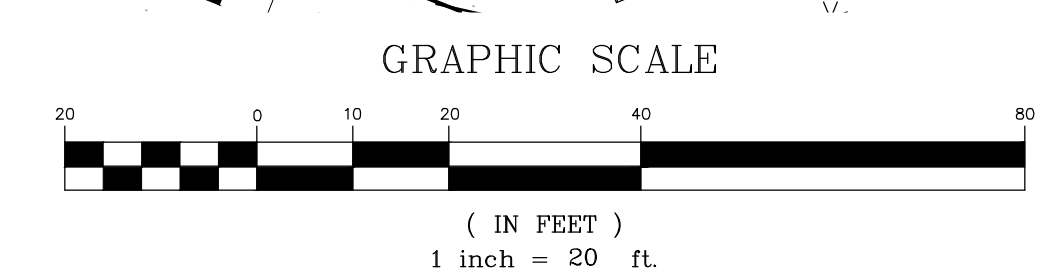

P:\MISC\DWG\2020\13127.dwg (Rev. 11/27/20) 11/27/20 10:52:21 AM

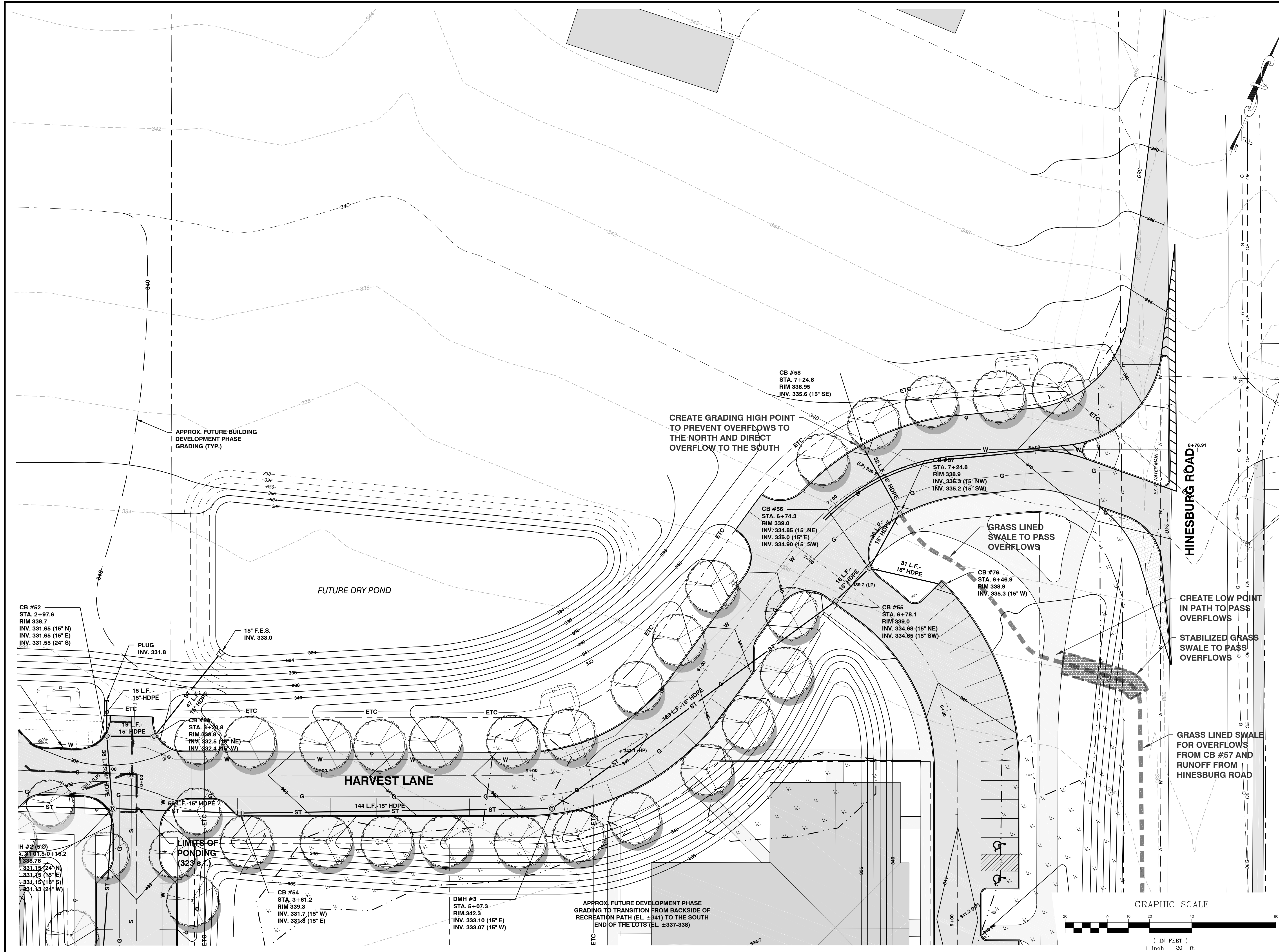

SITE ENGINEER:

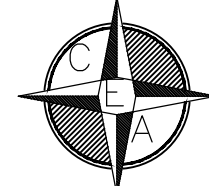

CIVIL ENGINEERING ASSOCIATES, INC.
 10 MANSFIELD VIEW LANE, SOUTH BURLINGTON, VT 05403
 802-864-2323 FAX: 802-864-2271 web: www.cca-vt.com

COPYRIGHT © 2010 - ALL RIGHTS RESERVED

DRAWN
 SAL
 CHECKED
 DSM
 APPROVED
 DSM

OWNER:
**HAYSTACK
 CROSSING, LLC**
 c/o JOSEPH BISSONETTE

88 RANDALL STREET
 SOUTH BURLINGTON, VT 05403

APPLICANT:
**BLACKROCK
 CONSTRUCTION, LLC**
 88 RANDALL STREET
 SOUTH BURLINGTON, VT 05403

PROJECT:
**HAYSTACK
 CROSSING**

SHELBURNE FALLS ROAD
 VERMONT ROUTE 116
 HINESBURG, VERMONT 05461



LOCATION MAP 1" = 2000'

DATE	CHECKED	REVISION

**PARTIAL SITE PLAN
 GRADING &
 DRAINAGE**

DATE
 JUN., 2020
 SCALE
 1" = 20'
 PROJ. NO.
 13127
 DRAWING NUMBER
C3.5

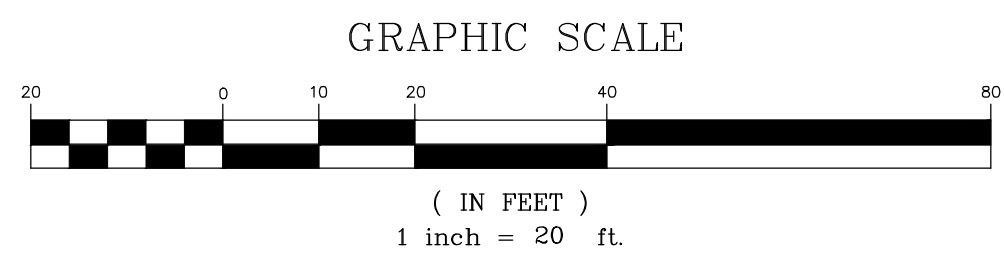

APPROX. FUTURE DEVELOPMENT PHASE
 GRADING TO TRANSITION FROM BACKSIDE OF
 RECREATION PATH (EL. ±341) TO THE SOUTH
 END OF THE LOTS (EL. ±337-338)

APPROX. FUTURE BUILDING
 DEVELOPMENT PHASE
 GRADING (TYP.)

CREATE GRADING HIGH POINT
 TO PREVENT OVERFLOWS TO
 THE NORTH AND DIRECT
 OVERFLOW TO THE SOUTH

GRASS LINED
 SWALE TO PASS
 OVERFLOWS

CREATE LOW POINT
 IN PATH TO PASS
 OVERFLOWS

STABILIZED GRASS
 SWALE TO PASS
 OVERFLOWS

GRASS LINED SWALE
 FOR OVERFLOWS
 FROM CB #57 AND
 RUNOFF FROM
 HINESBURG ROAD

LIMITS OF
 PONDING
 (323 s.f.)

CB #52
 STA. 2+97.6
 RIM 338.7
 INV. 331.65 (15" N)
 INV. 331.65 (15" E)
 INV. 331.55 (24" S)

PLUG
 INV. 331.8

15' F.E.S.
 INV. 333.0

CB #54
 STA. 3+20.8
 RIM 336.8
 INV. 332.5 (15" NE)
 INV. 332.4 (15" W)

CB #54
 STA. 3+61.2
 RIM 339.3
 INV. 331.7 (15" W)
 INV. 331.6 (15" E)

DMH #3
 STA. 5+07.3
 RIM 342.3
 INV. 333.10 (15" E)
 INV. 333.07 (15" W)

CB #58
 STA. 7+24.8
 RIM 338.95
 INV. 335.6 (15" SE)

CB #57
 STA. 7+24.8
 RIM 338.9
 INV. 335.3 (15" NW)
 INV. 335.2 (15" SW)

CB #56
 STA. 6+74.3
 RIM 339.0
 INV. 334.85 (15" NE)
 INV. 335.0 (15" E)
 INV. 334.90 (15" SW)

CB #55
 STA. 6+78.1
 RIM 339.0
 INV. 334.68 (15" NE)
 INV. 334.85 (15" SW)

CB #76
 STA. 6+46.9
 RIM 338.9
 INV. 335.3 (15" W)

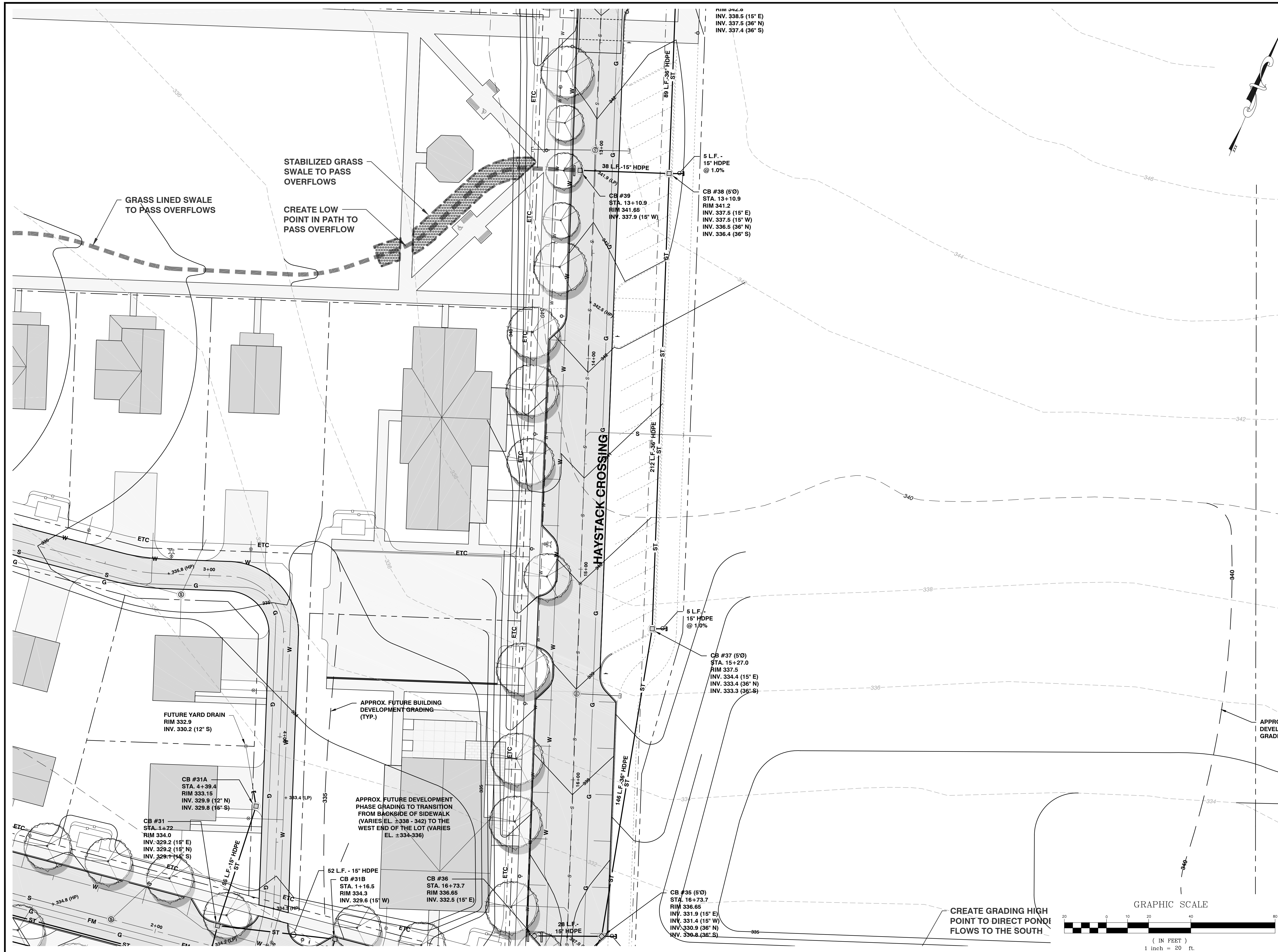

SITE ENGINEER:

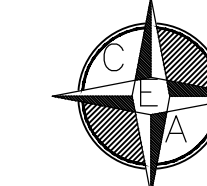

CIVIL ENGINEERING ASSOCIATES, INC.
10 MANSFIELD VIEW LANE, SOUTH BURLINGTON, VT 05403
802-864-2323 FAX: 802-864-2271 web: www.cca-vt.com

COPYRIGHT © 2010 - ALL RIGHTS RESERVED

DRAWN
SAL
CHECKED
DSM
APPROVED
DSM

OWNER:
**HAYSTACK
CROSSING, LLC**
c/o JOSEPH BISSONETTE

88 RANDALL STREET
SOUTH BURLINGTON, VT 05403

APPLICANT:
**BLACKROCK
CONSTRUCTION, LLC**
88 RANDALL STREET
SOUTH BURLINGTON, VT 05403

PROJECT:
**HAYSTACK
CROSSING**

SHELBURNE FALLS ROAD
VERMONT ROUTE 116
HINESBURG, VERMONT 05461

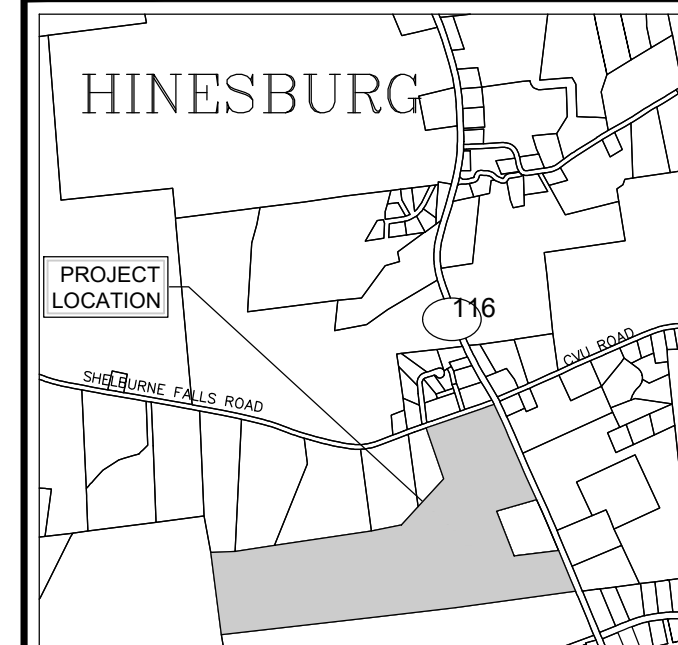

LOCATION MAP
1" = 2000'

DATE	CHECKED	REVISION

**PARTIAL SITE PLAN
GRADING &
DRAINAGE**

DATE
JUN., 2020
SCALE
1" = 20'
PROJ. NO.
13127

DRAWING NUMBER
C3.6

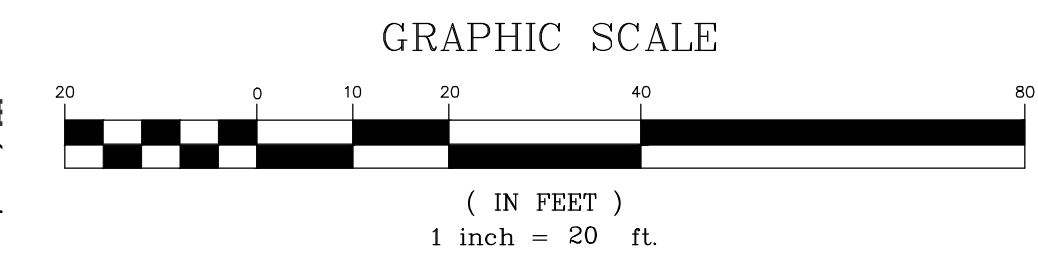

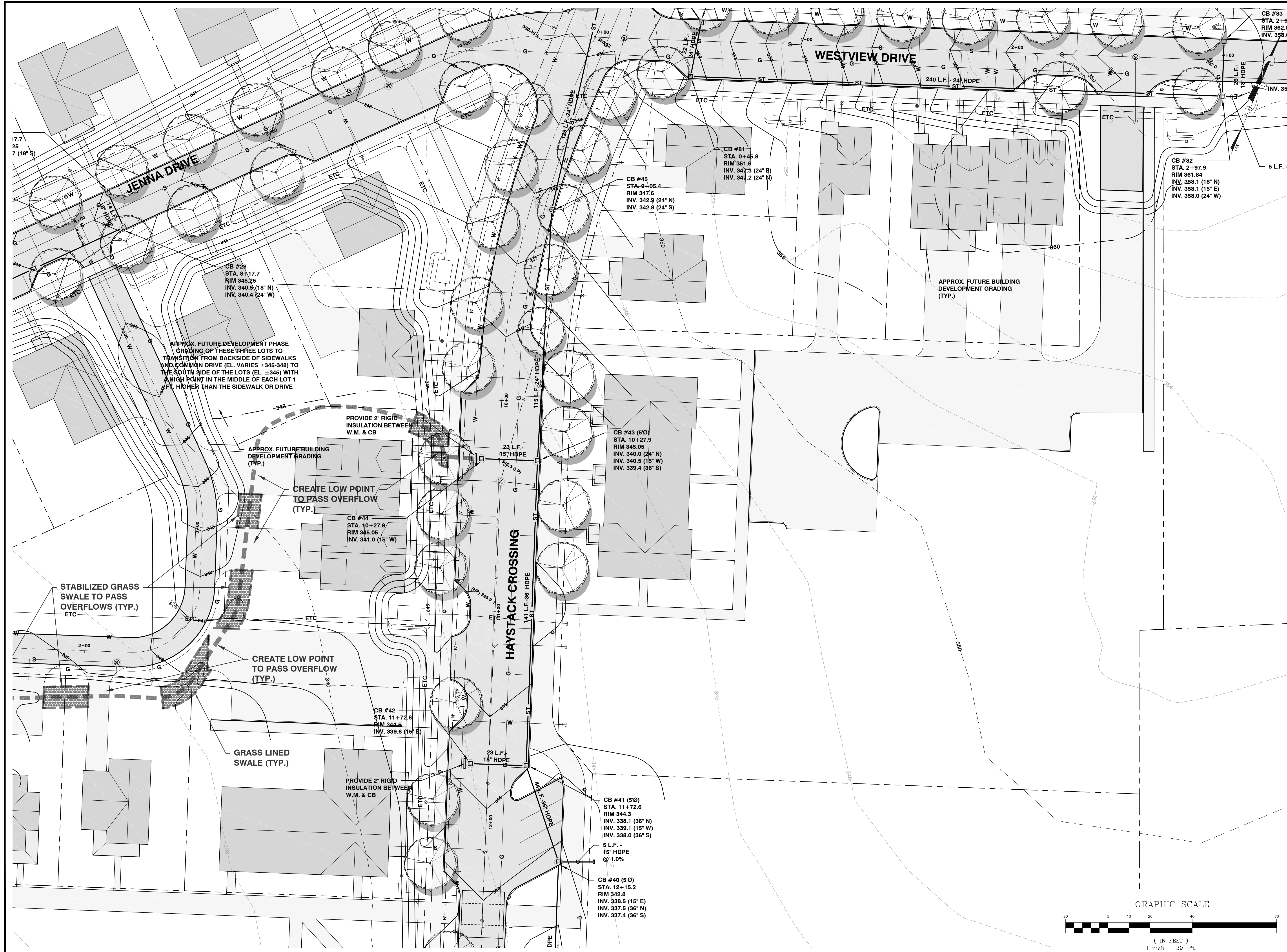

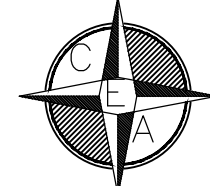
SITE ENGINEER:

 CIVIL ENGINEERING ASSOCIATES, INC.
 10 MANSFIELD VIEW LANE, SOUTH BURLINGTON, VT 05403
 802-864-2323 FAX: 802-864-2271 web: www.cca-vt.com
 COPYRIGHT © 2010 - ALL RIGHTS RESERVED

DRAWN
 SAL
 CHECKED
 DSM
 APPROVED
 DSM

OWNER:
HAYSTACK CROSSING, LLC
 c/o JOSEPH BISSONETTE
 68 RANDALL STREET
 SOUTH BURLINGTON, VT 05403
 APPLICANT:
BLACKROCK CONSTRUCTION, LLC
 68 RANDALL STREET
 SOUTH BURLINGTON, VT 05403

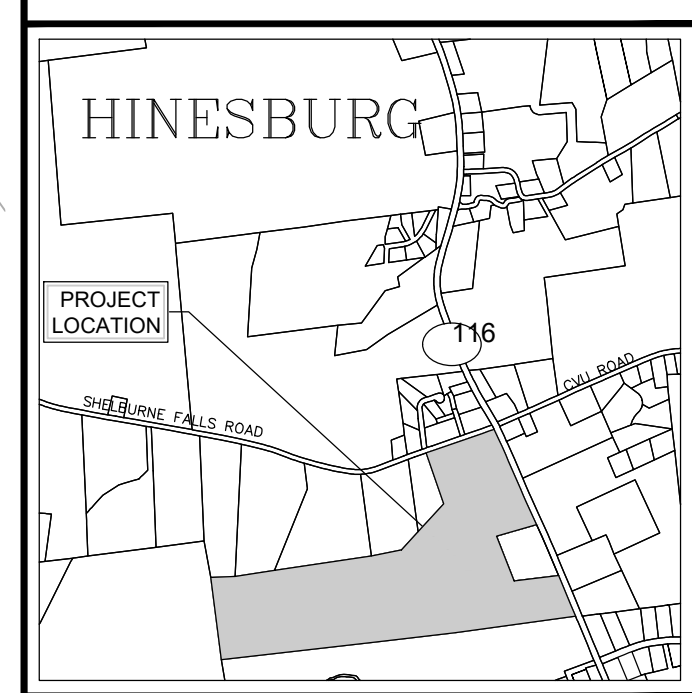
PROJECT:
HAYSTACK CROSSING
 SHELBURNE FALLS ROAD
 VERMONT ROUTE 116
 HINESBURG, VERMONT 05461



LOCATION MAP
 1" = 2000'

DATE	CHECKED	REVISION

**PARTIAL SITE PLAN
 GRADING &
 DRAINAGE**

DATE
 JUN., 2020
 SCALE
 1" = 20'
 PROJ. NO.
 13127
 DRAWING NUMBER
C3.8

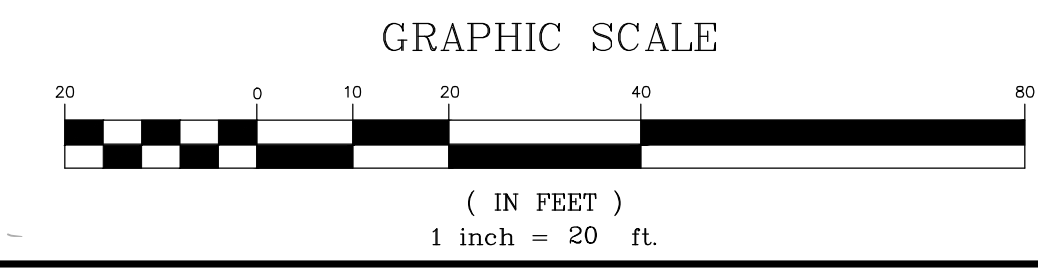

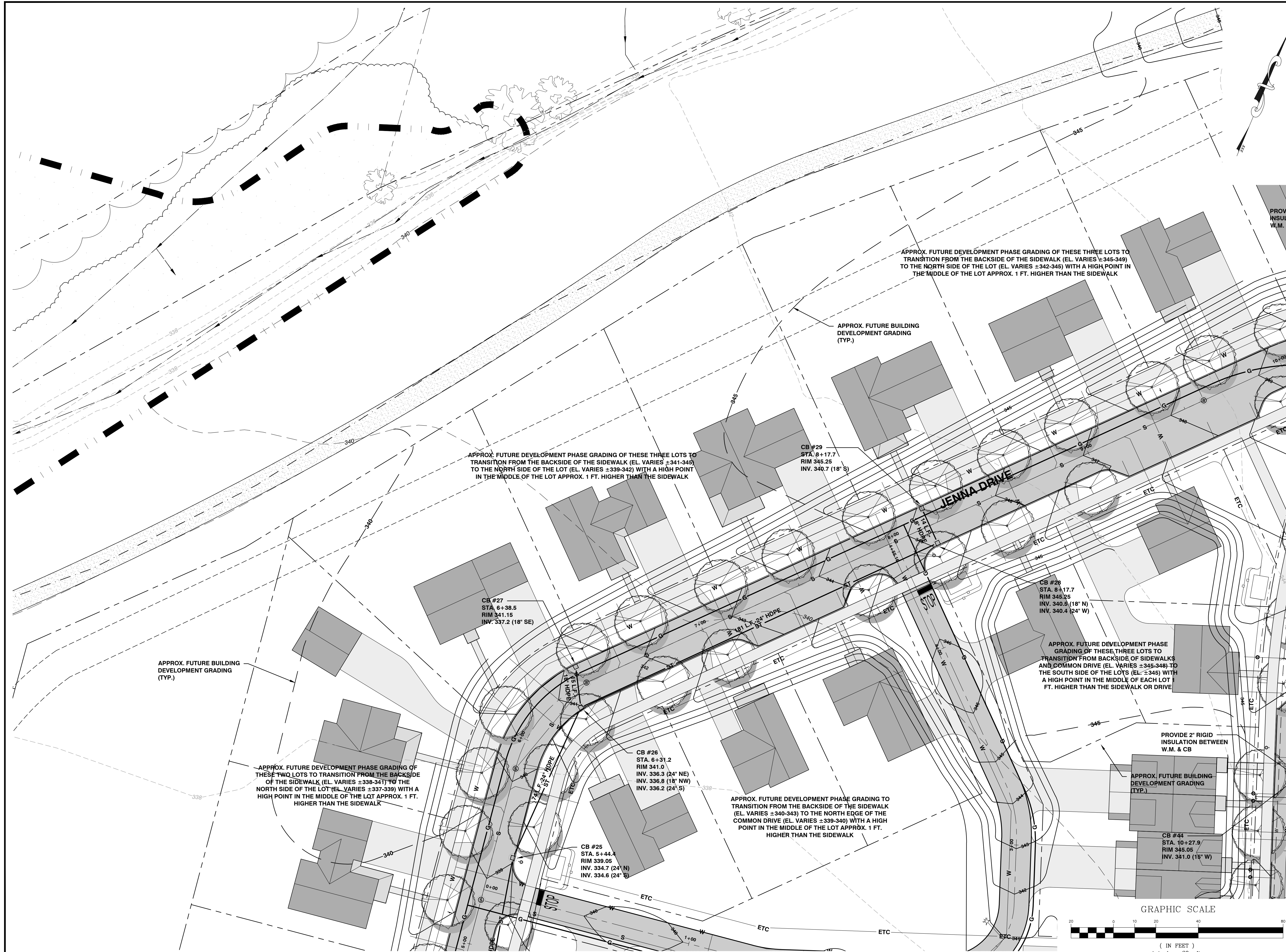

SITE ENGINEER:

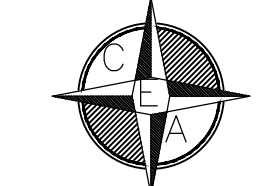

CIVIL ENGINEERING ASSOCIATES, INC.
 10 MANSFIELD VIEW LANE, SOUTH BURLINGTON, VT 05403
 802-864-2323 FAX: 802-864-2271 web: www.cca-vt.com

COPYRIGHT © 2010 - ALL RIGHTS RESERVED

DRAWN: SAL
 CHECKED: DSM
 APPROVED: DSM

OWNER:
HAYSTACK CROSSING, LLC
 c/o JOSEPH BISSONETTE

68 RANDALL STREET
 SOUTH BURLINGTON, VT 05403

APPLICANT:
BLACKROCK CONSTRUCTION, LLC
 68 RANDALL STREET
 SOUTH BURLINGTON, VT 05403

PROJECT:
HAYSTACK CROSSING
 SHELBURNE FALLS ROAD
 VERMONT ROUTE 116
 HINESBURG, VERMONT 05461

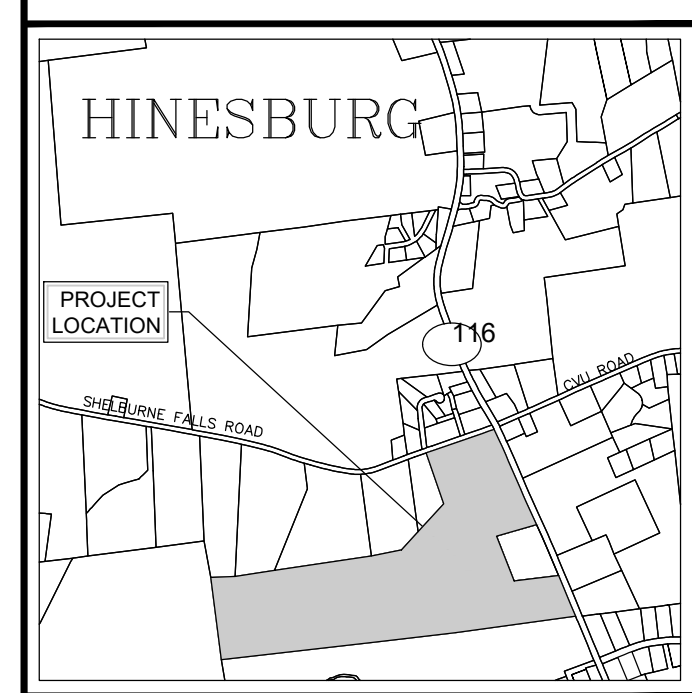

LOCATION MAP 1" = 2000'

DATE	CHECKED	REVISION

**PARTIAL SITE PLAN
 GRADING &
 DRAINAGE**

DATE: JUN., 2020
 SCALE: 1" = 20'
 PROJ. NO.: 13127
 DRAWING NUMBER: **C3.9**

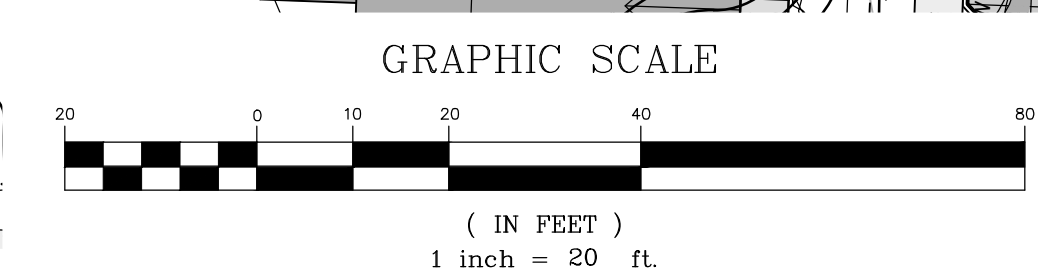

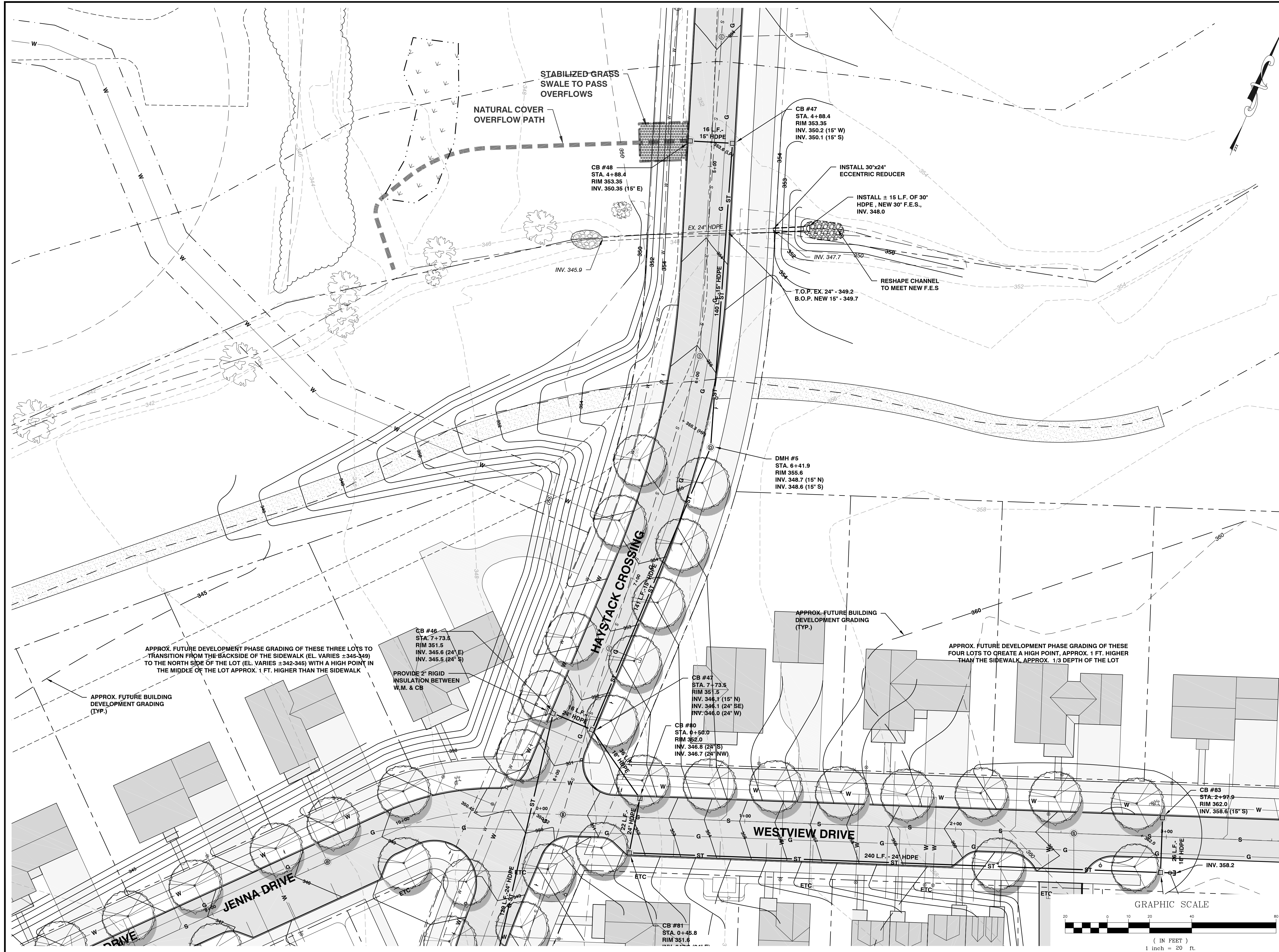

SITE ENGINEER:

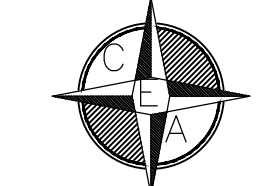

CIVIL ENGINEERING ASSOCIATES, INC.
 10 MANSFIELD VIEW LANE, SOUTH BURLINGTON, VT 05403
 802-864-2323 FAX: 802-864-2271 web: www.cca-vt.com

COPYRIGHT © 2019 - ALL RIGHTS RESERVED

DRAWN
SAL
 CHECKED
DSM
 APPROVED
DSM

OWNER:
**HAYSTACK
 CROSSING, LLC**
 c/o JOSEPH BISSONETTE

68 RANDALL STREET
 SOUTH BURLINGTON, VT 05403

APPLICANT:
**BLACKROCK
 CONSTRUCTION, LLC**
 68 RANDALL STREET
 SOUTH BURLINGTON, VT 05403

PROJECT:
**HAYSTACK
 CROSSING**
 SHELburne FALLS ROAD
 VERMONT ROUTE 116
 HINESBURG, VERMONT 05461

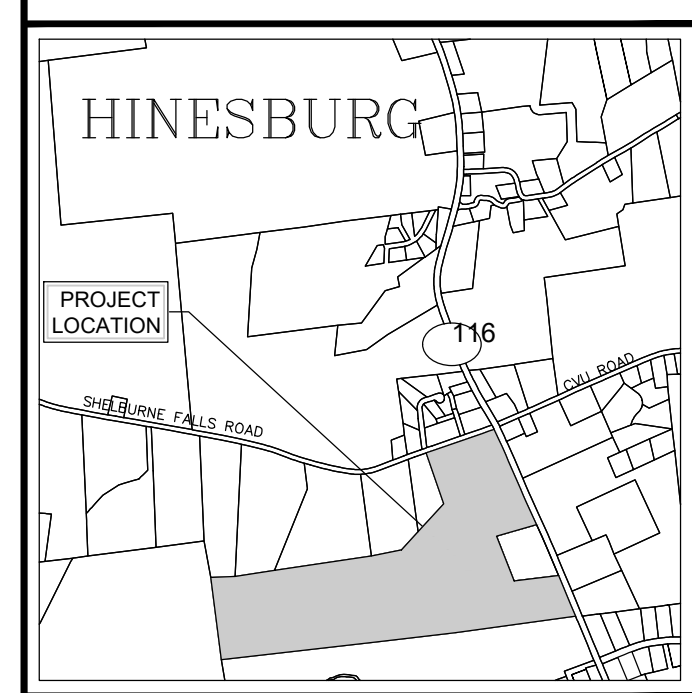

LOCATION MAP
 1" = 2000'

DATE	CHECKED	REVISION

**PARTIAL SITE PLAN
 GRADING &
 DRAINAGE**

DATE
JUN., 2020
 SCALE
1" = 20'
 PROJ. NO.
13127
 DRAWING NUMBER
C3.10

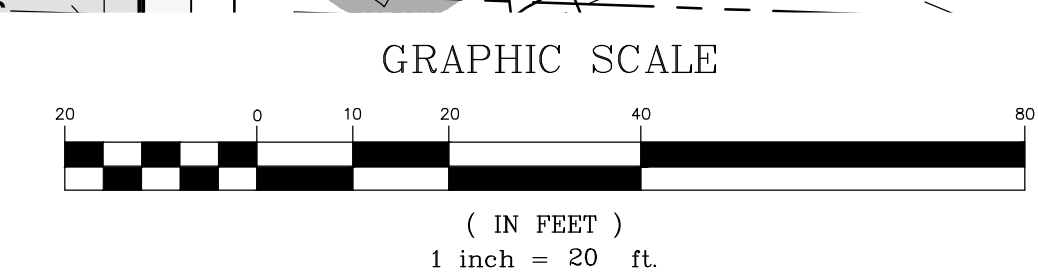

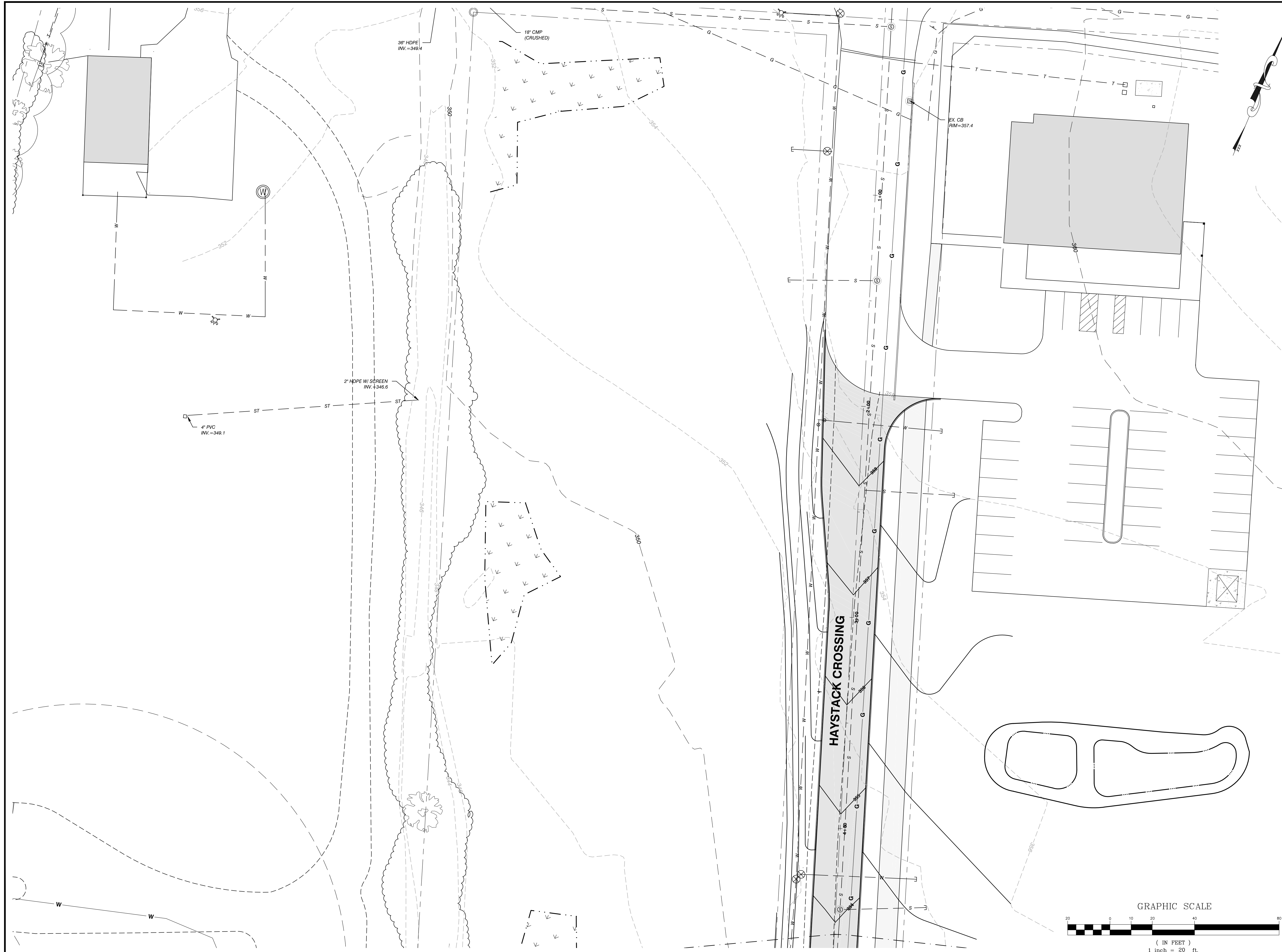

SITE ENGINEER:

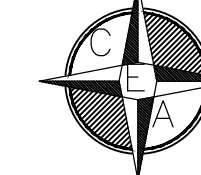

CIVIL ENGINEERING ASSOCIATES, INC.
 10 MANSFIELD VIEW LANE, SOUTH BURLINGTON, VT 05403
 802-864-2323 FAX: 802-864-2271 web: www.cca-vt.com

COPYRIGHT © 2019 - ALL RIGHTS RESERVED

DRAWN
SAL
 CHECKED
DSM
 APPROVED
DSM

OWNER:
**HAYSTACK
 CROSSING, LLC**
 c/o JOSEPH BISSONETTE

88 RANDALL STREET
 SOUTH BURLINGTON, VT 05403

APPLICANT:
**BLACKROCK
 CONSTRUCTION, LLC**

88 RANDALL STREET
 SOUTH BURLINGTON, VT 05403

PROJECT:

**HAYSTACK
 CROSSING**

SHELBURNE FALLS ROAD
 VERMONT ROUTE 116
 HINESBURG, VERMONT 05461

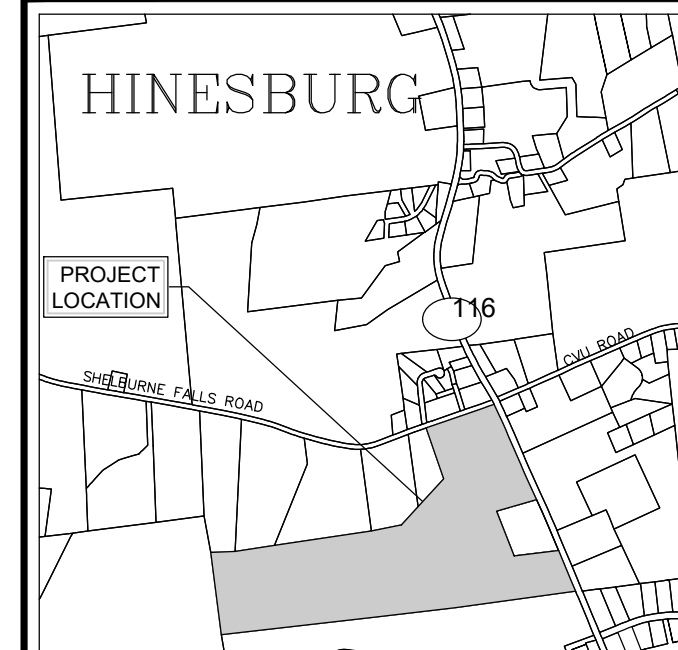

LOCATION MAP

1" = 2000'

DATE	CHECKED	REVISION

**PARTIAL SITE PLAN
 GRADING &
 DRAINAGE**

DATE
JUN., 2020

SCALE

1" = 20'

PROJ. NO.
13127

DRAWING NUMBER

C3.11

