

1 Roof Framing Plan  
1/8" = 1'-0"

GENERAL NOTES:

1. THE WORK OUTLINED ON THIS PLAN IS TEMPORARY ONLY. A PERMANENT REPAIR TO THE ROOF FRAMING IS TO BE COMPLETED WITHIN A TWO YEAR PERIOD. THE EXISTING ROOF FRAMING IS TO BE REVIEW EVERY 6 MONTHS OR LESS UNTIL A PERMANENT STRUCTURE IS IN PLACE.
2. THE GENERAL CONTRACTOR IS TO REVIEW ALL THE NEW AND EXISTING FRAMING FOR DAMAGED, CRACKED OR BROKEN FRAMING AND REPORT FINDINGS TO THE ENGINEER.

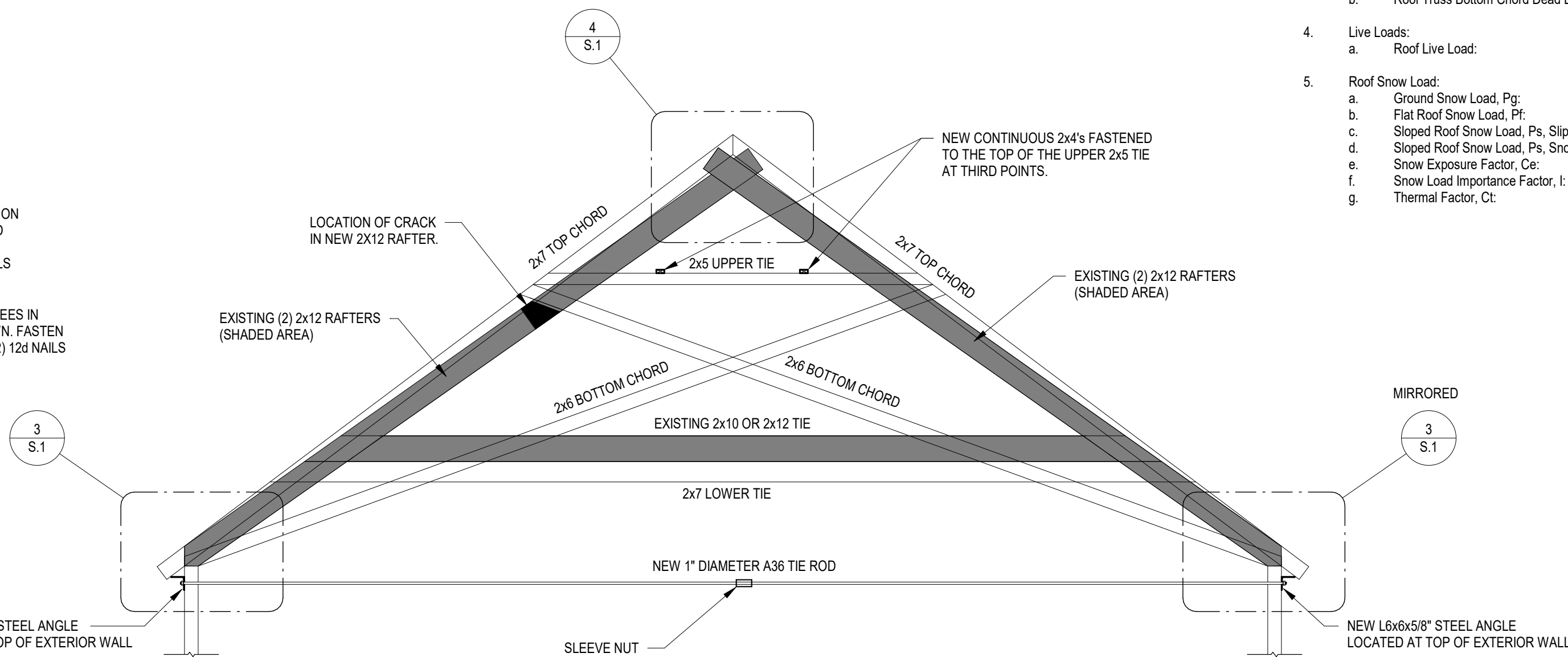

2 ROOF TRUSS SECTION  
1/4" = 1'-0"

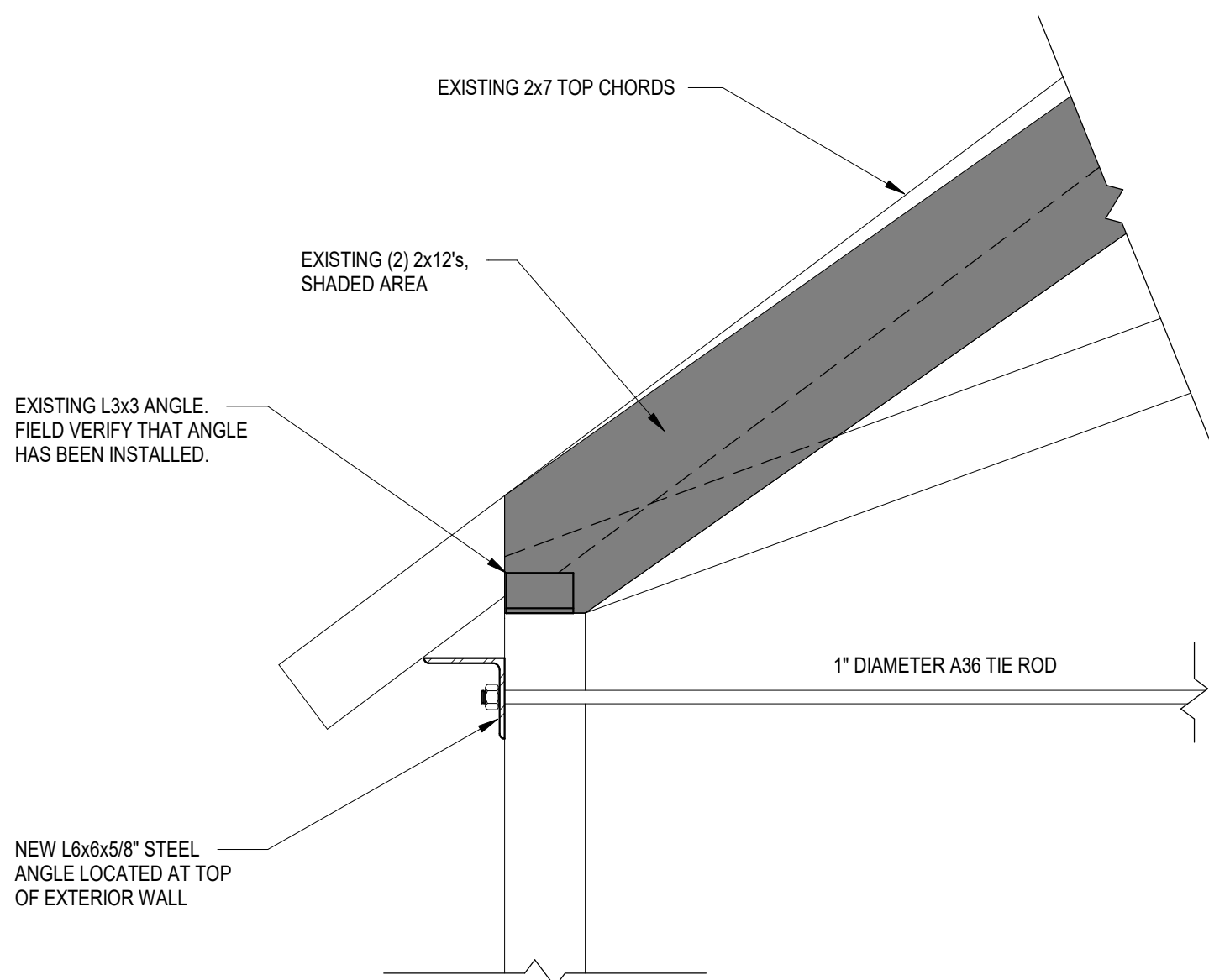

3 DETAIL AT EXTERIOR WALL  
1" = 1'-0"

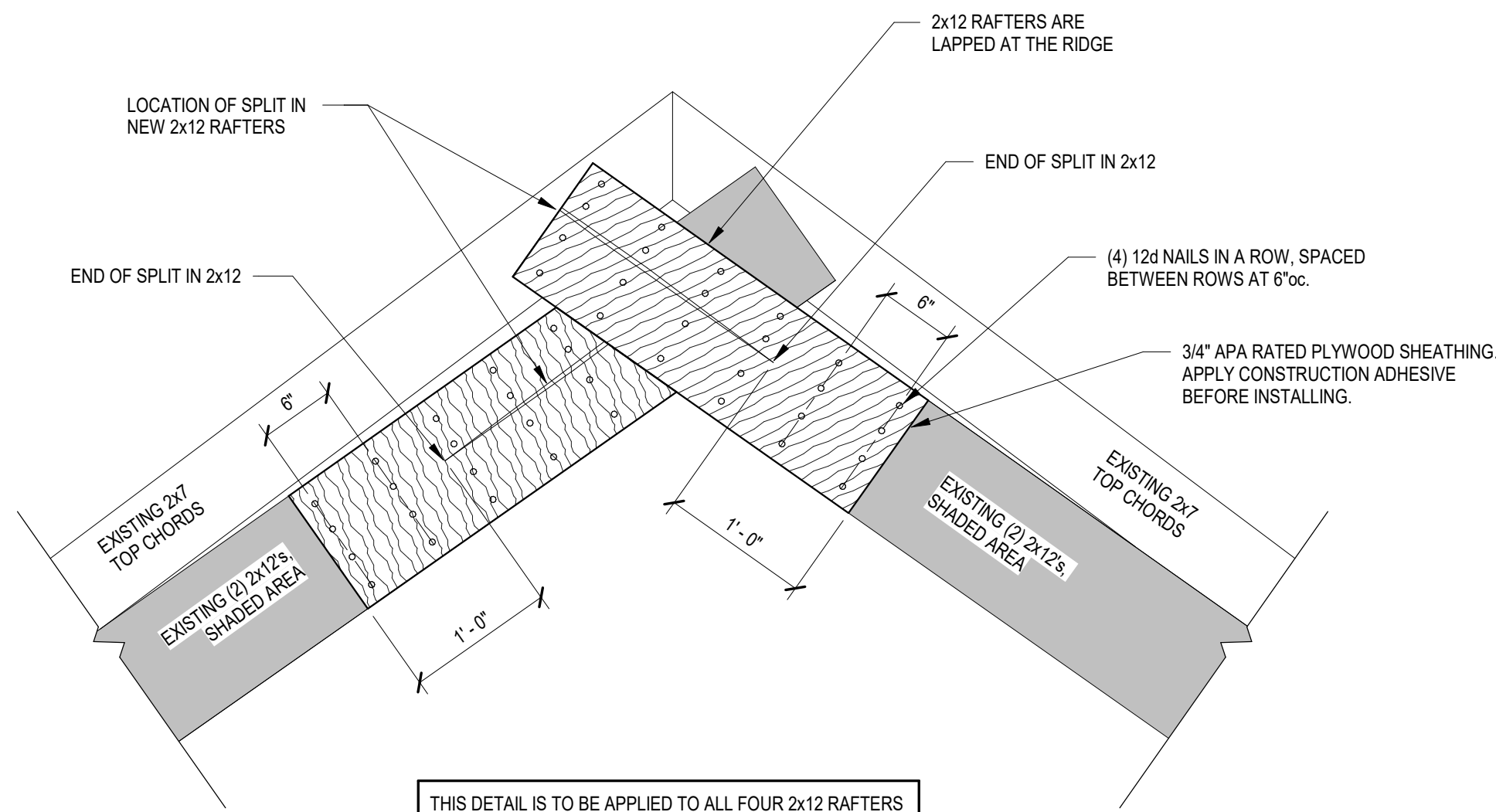

4 DETAIL AT RIDGE  
1" = 1'-0"

BASIS OF DESIGN

1. Building Code: The Vermont State Building Code Adopting the 2015 International Building Code with Amendments
2. Location: Hinesburg, Vermont
3. Dead Loads:
  - a. Roof Truss Top Chord Dead Load: 15psf
  - b. Roof Truss Bottom Chord Dead Load: 12psf
4. Live Loads:
  - a. Roof Live Load: Snow Load Governs
5. Roof Snow Load:
  - a. Ground Snow Load, Pg: 50psf
  - b. Flat Roof Snow Load, Pf: 42 psf
  - c. Sloped Roof Snow Load, Ps: Slippery Roof: 22psf
  - d. Sloped Roof Snow Load, Ps: Snow Guards: 40psf
  - e. Snow Exposure Factor, Ce: 1.0
  - f. Snow Load Importance Factor, I: 1.0
  - g. Thermal Factor, Ct: 1.1

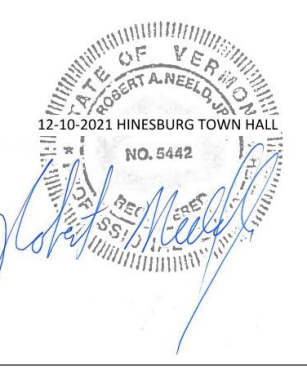

No.	Description	Date

**ENGINEERING VENTURES PC**  
208 Flynn Avenue, Suite 2A, Burlington, VT 05401  
tel. 802-863-6225 fax. 802-863-6306  
85 Mechanic Street, Suite B-2, Lebanon, NH 03766  
tel. 603-442-9333 fax. 603-442-9331  
www.engineeringventures.com

Town of Hinesburg  
Joy Dunin Grossman  
Assistant Town Manager  
10632 VT Route 116  
Hinesburg, Vermont 05461

Sheet Title: **ROOF FRAMING PLAN, SECTIONS AND DETAILS**  
Project Title: **Hinesburg Town Hall Roof Framing Stabilization**  
Hinesburg, Vermont

Designed By:	CRH
Checked By:	RAN
Drawn By:	CRH
Scale:	
Date:	12.10.2021

**S.1**

EV Project #Project Number