

SEE SHEET 3 FOR SITE PLAN (WEST)

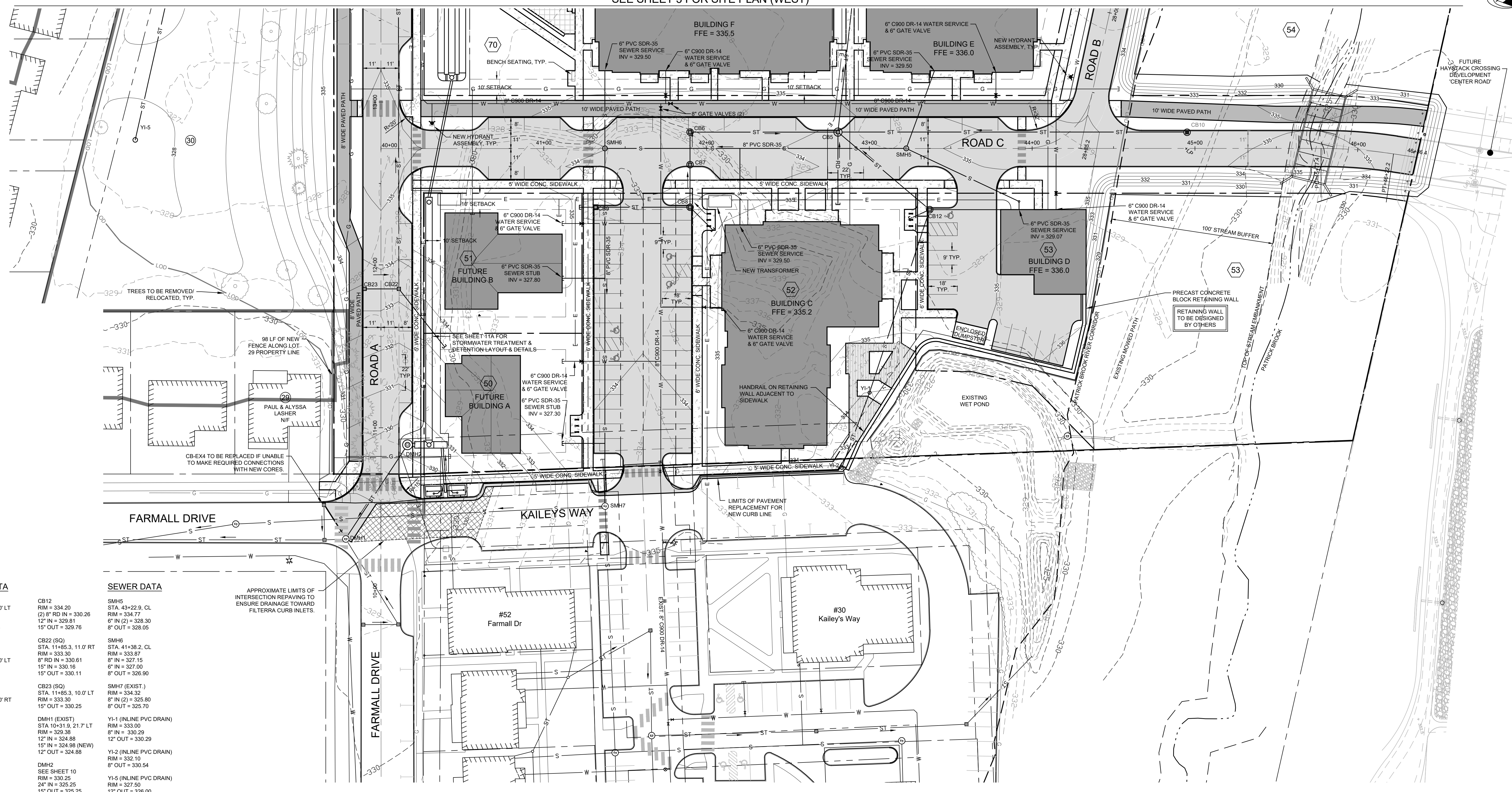
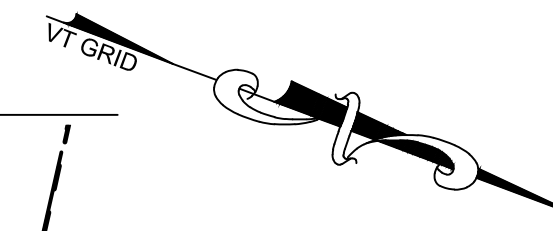

STORM DATA

CB5 (72" Ø) STA. 42+80.7, 10.0' LT RIM = 334.05 8" RD IN = 329.96 15" IN (2) = 329.46 18" IN = 329.46 30" OUT = 329.41	CB6 STA. 41+89.8, 10.0' LT RIM = 333.50 8" RD IN = 329.87 15" IN = 330.00 18" OUT = 329.82	CB7 STA. 41+89.8, 10.0' RT RIM = 333.50 8" IN = 330.25 15" OUT = 329.95	CB8 RIM = 333.40 8" RD IN = 330.60 12" IN = 330.15 15" OUT = 330.10	CB9 RIM = 333.40 8" RD IN = 330.88 12" OUT = 330.38	CB10 STA. 44+95.4, 10.0' LT RIM = 334.37 15" OUT = 330.33
--	---	---	---	--	--

SEWER DATA

SMH5 STA. 43+22.9, CL RIM = 334.77 8" IN (2) = 328.30 8" OUT = 328.05	SMH6 STA. 41+38.2, CL RIM = 333.87 8" IN = 327.15 15" IN = 330.16 8" OUT = 326.90	SMH7 (EXIST.) RIM = 334.32 8" IN (2) = 325.80 8" OUT = 325.70	YI-1 (INLINE PVC DRAIN) STA. 10+31.9, 21.7' LT RIM = 329.98 12" IN = 324.88 15" IN = 324.98 (NEW) 12" OUT = 324.88	YI-2 (INLINE PVC DRAIN) RIM = 332.10 8" OUT = 330.54	YI-5 (INLINE PVC DRAIN) RIM = 327.50 12" OUT = 326.00
---	--	--	---	--	---

APPROXIMATE LIMITS OF INTERSECTION REPAIRING TO ENSURE DRAINAGE TOWARD FILTERRA CURB INLETS.

LEGEND

	PROPOSED LOT LINE
	PROPOSED BUILDING SETBACK
	PROPOSED EASEMENT
	PROJECT PROPERTY LINE
	ABUTTER PROPERTY LINE
	EXISTING EASEMENT
	EXISTING CENTERLINE
	EXISTING CONTOUR MAJOR
	EXISTING CONTOUR MINOR
	EXISTING STREAM
	EXISTING RIVER CORRIDOR
	WETLAND BOUNDARY
	EXISTING SEWER MAIN, SEWER MANHOLE
	EXISTING WATER MAIN, VALVE, HYDRANT
	EXISTING STORM PIPE, CATCH BASIN
	EXISTING OVERHEAD WIRE
	EXISTING GAS MAIN
	PROPOSED STOCKADE FENCE
	PROPOSED CHAINLINK FENCE
	PROPOSED WATER MAIN, STUB & CURB STOP, VALVE, HYDRANT
	PROPOSED SEWER MAIN, SERVICE STUB, SEWER MANHOLE
	PROPOSED GAS MAIN
	PROPOSED STORM PIPE, CATCH BASIN, DRAINAGE MANHOLE
	PROPOSED ROOFDRAIN
	PROPOSED CONTOUR MAJOR
	PROPOSED CONTOUR MINOR
	PROPOSED STONE RIP-RAP

NOTE: T. ROOF TOP RUNOFF FROM BUILDINGS A, B, C & D SHALL BE CAPTURED AND TREATED BY THE PROPOSED HCCI STORMWATER SYSTEM VIA DISCONNECTION OR GLITTER SYSTEM INLETTING INTO THE HCCI STORMWATER SEWER SYSTEM. NO ROOF TOP RUNOFF SHALL BE ROUTED AWAY FROM THE HCCI COLLECTION SYSTEM WITHOUT FIRST CONSULTING WITH THE DESIGN ENGINEER.

THIS PLAN WAS ORIGINALLY PREPARED BY LAMOUREUX & DICKINSON CONSULTING ENGINEERS, INC. EDITS TO THIS PLAN AFTER MAY 16, 2022 WERE PERFORMED BY TCE, INC. CLIENT AGREES TO INDEMNIFY AND HOLD HARMLESS TCE, INC. FROM ANY DAMAGES, LIABILITIES OR COSTS, INCLUDING REASONABLE ATTORNEY'S FEES AND DEFENSE COSTS, ARISING OR ALLEGEDLY ARISING FROM ANY NEGLIGENT ACTS, ERRORS OR OMISSIONS BY ANY PRIOR CONSULTANT RETAINED BY THE CLIENT FOR THIS PROJECT.

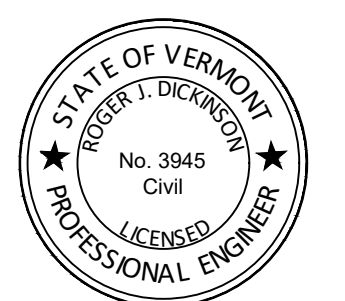
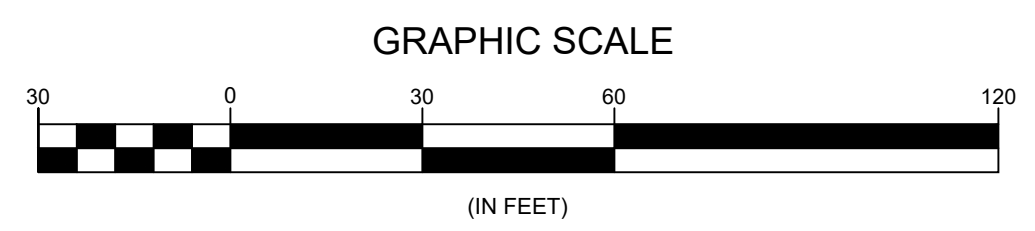

Date	Revision	By
08/19/22	EDITS TO ADDRESS STATE SW COMMENTS	MMI
08/08/22	REV. PATRICK BRK XING	RD
04/22/22	NEW BUILDING C FOOTPRINT, ADDED YI-1 & YI-2 INLETS, DELETED SIDEWALK BTW LOTS 50 & 51	RD
11/05/21	REV. LAYOUT & PATRICK BROOK RIVER CORRIDOR	NDS
12/14/20	ADDED FILTERRA TREATMENT UNITS	NDS
10/20/20	REVISED STORMWATER DESIGN & SITE GRADING	NDS
09/08/20	REVISED ROAD DIMENSIONS	NDS
06/16/20	REVISED STORMWATER DESIGN	NDS

These plans shall only be used for the purpose shown below:
 Sketch/Concept
 Preliminary
 Final
 Act 250 Review
 Construction
 Record Drawing

LANDS OF
HINESBURG CENTER, LLC
 VT Route 116 Hinesburg, VT

PROPOSED SITE PLAN (EAST)

Lamoureux & Dickinson
 Consulting Engineers, Inc.
 14 Morse Drive, Essex, VT 05452
 802-878-4450 www.LDengineering.com

Project No. 19054
 Survey N/A
 Design NDS/RD
 Drawn DLH
 Checked RJD
 Date 5/11/22
 Scale AS NOTED
 Sheet number 2